

# Birch™ 8" New Construction Plaster Frame

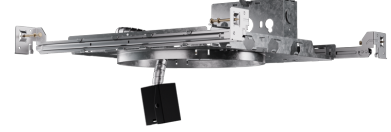

## Features

- New Construction Plaster frame with hanger bars
- Encased Quick Connect for easy module installation and maintenance
- Optional 90 minutes Emergency Battery Backup

## Technical Details

**Construction:** Constructed from 16 gauge galvanized steel for large architectural applications

**Installation:** Designed for commercial buildings. Easily installed with included hanger bars. Light engine installed into frame

**Junction Box:** Positioned to accommodate straight conduit runs. 1/2" trade size conduit knockouts and pry-out knockout slots for easy romex installation

**Warranty:** ELCO Products are built to last. 5-year Limited warranty

## Options



**Optional Battery Backup**

## Dimensions

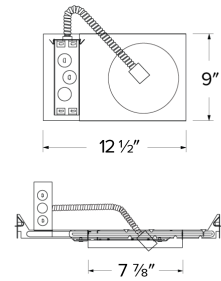

## Product Number

| Item   | Description                    |
|--------|--------------------------------|
| ELB8PF | New Construction Plaster Frame |

## Product Number Builder Example: ELB8PF

Birch™ 8" New Construction Plaster Frame

Optional

**ELB8PF**

No Battery Backup  
-EM5 Emergency Battery Backup

# Compatible Products



For use with **Birch™ Plater Frames**

## Birch™ LED Modules

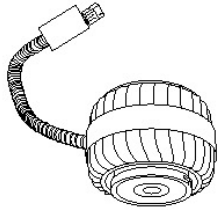

**Birch™ Pro** LED Module with 5-CCT Switch (750 lm - 1500 lm)



| CAT NO.      | COLOR TEMPERATURE                                    | SPECIFICATIONS   |
|--------------|--|--|
| ELB15RCT5ICA | 5-CCT Switch<br>2700K, 3000K, 3500K,<br>4000K, 5000K | <ul style="list-style-type: none"> <li>• IC Rated, for use in IC and Non-IC applications</li> <li>• 750 lm - 1500 lm (10W - 20W)</li> <li>• Beam Angle adjustment from 25°-45°</li> <li>• 120/277V input with 0-10V dimming</li> </ul> |

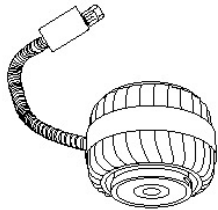

**Birch™ High Lumen** LED Module (1250 lm - 3000 lm)



| CAT NO.  | COLOR TEMPERATURE | SPECIFICATIONS   |
|----------|-------------------|--|
| ELB30R30 | 3000K             | <ul style="list-style-type: none"> <li>• Non-IC, for use in Non-IC applications</li> <li>• 1250 lm - 3000 lm (13W - 30W)</li> <li>• Beam Angle adjustment from 22°-50°</li> <li>• 120/277V input with 0-10V dimming</li> </ul> |
| ELB30R35 | 3500K             |  |
| ELB30R40 | 4000K             |  |

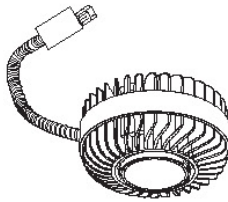

**Birch™ High Lumen** LED Module (3200 lm - 5000 lm)



| CAT NO.  | COLOR TEMPERATURE | SPECIFICATIONS  |
|----------|-------------------|---|
| ELB50R30 | 3000K             | <ul style="list-style-type: none"> <li>• Non-IC, for use in Non-IC applications</li> <li>• 3200 lm - 5000 lm (32W - 55W)</li> <li>• Beam Angle adjustment from 22°-50°</li> <li>• 120/277V input with 0-10V dimming</li> <li>• Works with 6" &amp; 8" Trims (ELB610 &amp; ELB810 only)</li> </ul> |
| ELB50R35 | 3500K             |   |
| ELB50R40 | 4000K             |   |

## 4", 6", & 8" Birch™ Twist-On Trims



**4" Round Reflector**



**6" Round Reflector**

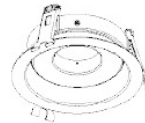

**6" Round Adjustable Reflector**



**8" Round Reflector**

| CAT NO.  | SPECIFICATIONS              | CAT NO.  | SPECIFICATIONS              | CAT NO. | SPECIFICATIONS              | CAT NO. | SPECIFICATIONS              |
|----------|-----------------------------|----------|-----------------------------|---------|-----------------------------|---------|-----------------------------|
| ELB410W  | All White                   | ELB610W  | All White                   | ELB629W | All White                   | ELB810W | All White                   |
| ELB410BB | All Black                   | ELB610BB | All Black                   | ELB629B | All Black                   | ELB810H | All Haze<br>(Semi-Specular) |
| ELB410H  | All Haze<br>(Semi-Specular) | ELB610H  | All Haze<br>(Semi-Specular) | ELB629H | All Haze<br>(Semi-Specular) |         |                             |
| ELB410HW | Haze/White Trim             | ELB610HW | Haze/White Trim             |         |                             |         |                             |

• Not compatible with ELB50R Module Series

• Not compatible with ELB50R Module Series