

Birch™ 4" New Construction Plaster Frame

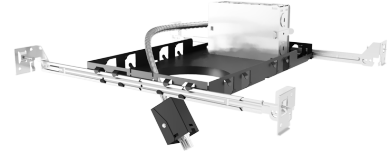

Features

- New Construction Plaster frame with hanger bars
- Encased Quick Connect for easy module installation and maintenance
- Optional 90 minutes Emergency Battery Backup

Technical Details

Construction: Constructed from 16 gauge galvanized steel for large architectural applications

Installation: Designed for commercial buildings. Easily installed with included hanger bars. Light engine installed into frame

Junction Box: Positioned to accommodate straight conduit runs. 1/2" trade size conduit knockouts and pry-out knockout slots for easy romex installation

Warranty: ELCO Products are built to last. 5-year Limited warranty

Options



Optional Battery Backup

Dimensions

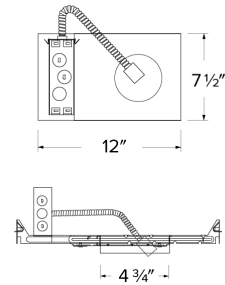

Product Number

Item	Description
ELB4PF	New Construction Plaster Frame

Product Number Builder Example: ELB4PF

Birch™ 4" New Construction Plaster Frame

ELB4PF

Optional

No Battery Backup
-EM5 Emergency Battery Backup

Compatible Products



For use with **Birch™ Plater Frames**

Birch™ LED Modules

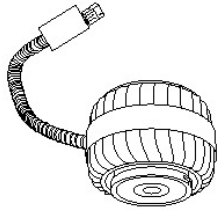

Birch™ Pro LED Module with 5-CCT Switch (750 lm - 1500 lm)



CAT NO.	COLOR TEMPERATURE	SPECIFICATIONS
ELB15RCT5ICA	5-CCT Switch 2700K, 3000K, 3500K, 4000K, 5000K	<ul style="list-style-type: none"> • IC Rated, for use in IC and Non-IC applications • 750 lm - 1500 lm (10W - 20W) • Beam Angle adjustment from 25°-45° • 120/277V input with 0-10V dimming

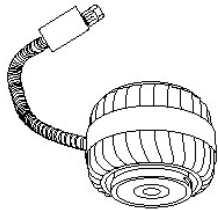

Birch™ High Lumen LED Module (1250 lm - 3000 lm)



CAT NO.	COLOR TEMPERATURE	SPECIFICATIONS
ELB30R30	3000K	<ul style="list-style-type: none"> • Non-IC, for use in Non-IC applications • 1250 lm - 3000 lm (13W - 30W) • Beam Angle adjustment from 22°-50° • 120/277V input with 0-10V dimming
ELB30R35	3500K	
ELB30R40	4000K	

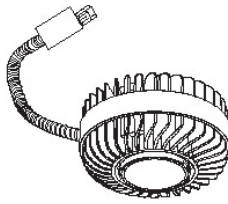

Birch™ High Lumen LED Module (3200 lm - 5000 lm)



CAT NO.	COLOR TEMPERATURE	SPECIFICATIONS
ELB50R30	3000K	<ul style="list-style-type: none"> • Non-IC, for use in Non-IC applications • 3200 lm - 5000 lm (32W - 55W) • Beam Angle adjustment from 22°-50° • 120/277V input with 0-10V dimming • Works with 6" & 8" Trims (ELB610 & ELB810 only)
ELB50R35	3500K	
ELB50R40	4000K	

4", 6", & 8" Birch™ Twist-On Trims



4" Round Reflector



6" Round Reflector

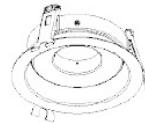

6" Round Adjustable Reflector



8" Round Reflector

CAT NO.	SPECIFICATIONS	CAT NO.	SPECIFICATIONS	CAT NO.	SPECIFICATIONS	CAT NO.	SPECIFICATIONS
ELB410W	All White	ELB610W	All White	ELB629W	All White	ELB810W	All White
ELB410BB	All Black	ELB610BB	All Black	ELB629B	All Black	ELB810H	All Haze (Semi-Specular)
ELB410H	All Haze (Semi-Specular)	ELB610H	All Haze (Semi-Specular)	ELB629H	All Haze (Semi-Specular)		
ELB410HW	Haze/White Trim	ELB610HW	Haze/White Trim				

• Not compatible with ELB50R Module Series

• Not compatible with ELB50R Module Series