

# 3" Koto™ Architectural Shallow Maximum Adjustability IC Airtight Housing



Koto™ Architectural Housing: 120/277V (0-10V/Triac/ELV) or 120V (Triac/ELV), and ICALWN (Lutron Athena Wireless Node) with optional Emergency Battery Backup. Must be used with Koto™ Architectural LED Light Engines (ELK19, ELK21, or ELK24 Series). Lumen output based on module.

## Features

- IC Airtight for direct contact with insulation.
- Easy-to-Remove driver.
- Optional 90 minutes, 120/277 VAC, 60Hz, Emergency Backup.
- Flicker-Free Dimming.
- USA designed and assembled.
- Limited 5 year warranty.
- For use with ELCO Koto™ Architectural LED Light Engines (ELK19, ELK21, or ELK24 Series).

## Specifications

<b>Wattage</b>	14.7W
<b>Lumens</b>	850 (ELK19) - 1100 (ELK21) - 1500 (ELK24) lm
<b>Voltage</b>	120/277V
<b>Dimmable</b>	0-10V/Triac/ELV
<b>Lamp Type</b>	LED
<b>Power Factor</b>	≥0.95
<b>Damp Location</b>	Listed

## Dimensions

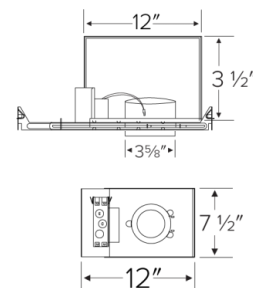

## Technical Details

**Construction:** Single Wall IC Rated for direct contact with insulation. For use in IC and Non-IC conditions. Up to 1100 lumens. Housing adjusts in frame to accommodate up to 1 1/2" ceiling thickness. Airtight housing with gasket to restrict airflow in accordance with ASTM E-283 air-tight requirements.

**Installation:** Designed for ceiling plenums where 2x6 joists or taller are used. High strength hanger bars can easily be nailed to joists. Suitable for T-grid and drop ceiling applications. See installation sheet for detailed information. Emergency Battery Back-up Option requires access from above. For use with ELCO Koto™ Architectural LED Light Engines (ELK19, ELK21, or ELK24 Series).

**Junction Box:** Positioned to accommodate straight conduit runs. Two 3/4" knockouts, Seven 1/2" trade size conduit knockouts, One 3/8" knockout. Four Pry-out knockout slots for easy romex installation.

**Hanger Bars:** Pre Installed hanger bars with True Nail easy installation in regular lumber, engineered lumber, and Laminated Beams. Integral T-bar slots for easy installation in T-Bars. Spans up 24" and can be repositioned 90°. Score lines allow for tool-free hanger bar size reduction. Integral leveling flange allows for single-person installation while easily aligning the housings with the joists.

**Electrical:** Driver is rated for 120V and 277V input (120/277V). High Efficiency driver with a power factor > 0.95.

**Emergency Battery Pack:** Optional 90 minute battery pack available with test indicator switch. Note that double wall housings require Access From Above Ceiling for Battery Maintenance.

**Dimmability:** 3-in-1 Dimming: Triac, ELV and 0-10V dimming in one driver. 0-10V Dimming down to 5% with a compatible dimmer. ICALWN - Lutron Athena Wireless Node. Can be specified with Lutron drivers for 0.1% and 1% dimming. For a full list of dimmers refer to the Dimmer Compatibility List.

**Listings:** cUL Listed for Damp Location and for Wet Location with select trims. cUL Listed for Direct Contact with Insulation and Combustible Material. cUL Listed for Feed Through.

## Product Number

Item	Description	Lamp type	Lumens	Watts	Voltage	Dimming
<b>E3LK77ICAD</b>	Shallow Maximum Adjustability Housing	LED	850 (ELK19) - 1100 (ELK21) - 1500 (ELK24) lm	14.7W	120/277V	0-10V/Triac/ELV

Product Number Builder

Example: E3LK76ICA

Koto™ Architectural Housing	Voltage	Dimming
<div>E3LK</div>	<div></div> <div>76 120V<sup>1</sup></div> <div>77 120/277V<sup>2</sup></div>	<div></div> <div>ICA Triac/ELV</div> <div>ICAD 0-10V/Triac/ELV</div> <div>ICADAL DALI 2</div> <div>ICAWAN Lutron Athena Wireless</div>

<sup>1</sup> Available as 120V, Triac/ELV only

<sup>2</sup> Available as 120/277V, 0-10V/Triac/ELV only

# Compatible Products

For use with Dedicated 3" Architectural ICA LED Housings

**EL** ELCO Lighting

## Koto™ Architectural LED Light Engine

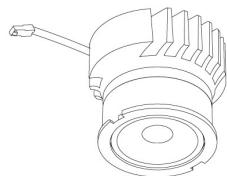

**Koto™ LED Light Engine**  
ELK21 & ELK24

PRODUCT NUMBER BUILDER			
Koto™ LED Light Engine	Lumens	Color Temperature	Beam Angle
ELK			
21	1100 - 1500 lm <sup>1</sup>	27D 2700K	(blank) 38° lens (Standard)
24	1100 - 1800 lm <sup>1</sup>	30D 3000K	-S 18° lens
		35D 3500K	-N 25° lens
		40D 4000K	-W 60° lens
			-FC 18° - 50° Adjustable (ELK21 Only)

<sup>1</sup>Wattage based on housing.

### ACCESSORIES



#### Lens

**EP731C** 18° Lens  
**EP732C** 25° Lens  
**EP733C** 38° Lens  
**EP734C** 60° Lens

<sup>\*</sup>EP732C, EP733C, EP734C Included



#### Snoot

**L50W** White  
**L50B** Black



#### Secondary Optics

**L45** Hex Louver  
**L46** Linear Lens  
**L47** Spread Louver  
**L49** Frosted Lens  
**L51** Color Shifter

## 3" Pex™ Twist-&-Lock Trims



#### Deep Reflector

**ELK3618**

Finishes:

(W, BB, BZ, B, C, H)



#### Adjustable Gimbal

**ELK3629**

Finishes:

(W, BB, BZ, B, C, H)

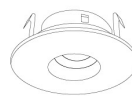

#### Adjustable Pinhole

**ELK3627**

Finishes:

(B, BB, BZ)

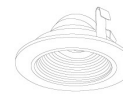

#### Adjustable Baffle

**ELK3693**

Finishes:

(W)



#### Slot Aperture

**ELK3620**

Finishes:

(W)



#### Adj. Reflector Wall Wash

**ELK3622**

Finishes:

(W)

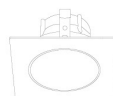

#### Sq. Deep Reflector

**ELK3318**

Finishes:

(W, BB, BZ, B, C, H)



#### Sq. Adjustable Gimbal

**ELK3329**

Finishes:

(W, BB, BZ, B, C, H)

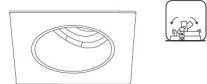

#### Sq. Adjustable Wall Wash

**ELK3322**

Finishes:

(W)

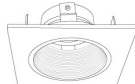

#### Sq. Adjustable Baffle

**ELK3393**

Finishes:

(W)



#### Sq. Adjustable Pinhole

**ELK3327**

Finishes:

(B, BB, BZ)

\*Finishes: **W** - All White, **BB** - All Black, **BZ** - All Bronze, **B** - Black Reflector w/White Ring, **C** - Chrome Reflector w/White Ring, **H** - Haze Reflector w/White Ring



Must be used  
with Maximum  
Adjustability Housing