

3" 0-10V New Construction 2-Hour Fire Rated IC Airtight Housing

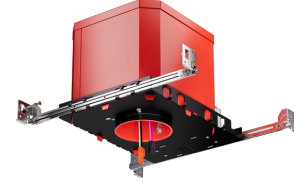

3" 2-Hour Fire Rated New Construction LED Housing compatible with 0-10V LED Koto™ Module.

Features

- Wired for 0-10V Dimming
- 120/277V Input
- Double Wall IC Airtight for direct contact with Insulation
- 2-Hour Fire Resistance to meet and exceed strict fire safety codes.
- Integrated Non-combustible insulation acts as a sound barrier minimizing sound transfer between floors.
- Meets Title 24 Requirements.
- ENERGY STAR® Certified.
- STC/ILC Sound Rated
- cUL Listed for Damp Locations
- cUL Listed for Wet Location with Wet Location Rated Inserts
- cUL Listed for Feed Through

Specifications

Voltage	120/277V
Dimmable	0-10V/Triac/ELV
Damp Location	Listed

Dimensions

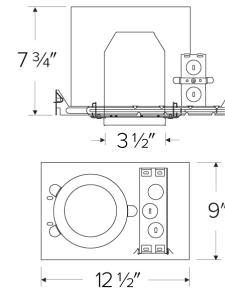

Technical Details

Construction:

- Double wall IC rated for direct contact with insulation. For use in IC and Non-IC conditions.
- Housing adjusts in frame to accommodate up to 1 1/2" ceiling thickness.
- Airtight housing with gasket to restrict airflow in accordance with ASTM E-283 air-tight requirements.

Installation: Designed for ceiling plenums where 2x8 joists or taller are used. High strength hanger bars can easily be nailed to joists. Suitable for T-grid and drop ceiling applications. See installation sheet for detailed information.

Junction Box: Positioned to accommodate straight conduit runs. Two 3/4" knockouts, Seven 1/2" trade size conduit knockouts, One 3/8" knockout. Four Pry-out knockout slots for easy romex installation.

Hanger Bars: Pre Installed hanger bars with True Nail easy installation in regular lumber, engineered lumber, and Laminated Beams. Integral T-bar slots for easy installation in T-Bars. Spans up 24" and can be repositioned 90°. Score lines allow for tool-free hanger bar size repositioning. Integral leveling flange allows for single-person installation while easily aligning the housings with the joists.

Electrical: Driver is rated for 120/277V. High Efficiency driver with a power factor > 0.9.

Emergency Battery Pack: Optional 90 minute battery pack available with test indicator switch. Note that double wall housings require Access From Above Ceiling for Battery Maintenance.

Listings: cUL Listed for Damp Location and for Wet Location with select trims. cUL Listed for Direct Contact with Insulation and Combustible Material. cUL Listed for Feed Through. Sound rated.

Warranty: ELCO Lighting warrants products will be free from defects in materials and workmanship for a period of 5 years.

Product Numbers

Item	Voltage	Dimming
EL39FICDXA	120/277V	0-10V/Triac/ELV

Compatible Products

For use with Dedicated 3" 0-10V Koto ICAD LED Housings

0-10V Koto™ LED Module

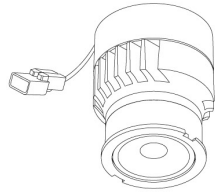

**0-10V Koto™
LED Module
ELK10DX**

PRODUCT NUMBER BUILDER				
0-10V Koto™ LED Module	Lumens	Voltage	Color Temperature	Beam Angle
ELK				
	10 1000 lm	DX 120/277V	27 2700K	(blank) 38° lens (Standard)
			30 3000K	-S 18° lens
			35 3500K	-N 25° lens
			40 4000K	-W 60° lens
			SD Sunset Dimming	

ACCESSORIES



Lens

- EP731C** 18° Lens
 - EP732C** 25° Lens
 - EP733C** 38° Lens
 - EP734C** 60° Lens
- *EP732C, EP733C, EP734C Included



Snout

- L50W** White
- L50B** Black



Secondary Optics

- L45** Hex Louver
- L46** Linear Lens
- L47** Spread Louver
- L49** Frosted Lens
- L51** Color Shifter

3" Pex™ Twist-On Trims



Recommended to be used with Maximum Adjustability Housing



Round Deep Reflector

ELK3618
Finishes:
(W, BB, BZ, B, C, H)

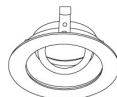

Round Adjustable Gimbal

ELK3629
Finishes:
(W, BB, BZ, B, C, H)

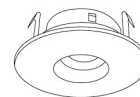

Round Adjustable Pinhole

ELK3627
Finishes:
(B, BB, BZ)

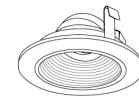

Round Adjustable Baffle

ELK3693
Finishes:
(W)



Round Adj. Slot Aperture

ELK3620
Finishes:
(W)



Round Adj. Wall Wash

ELK3622
Finishes:
(W)

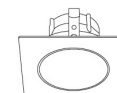

Square Deep Reflector

ELK3318
Finishes:
(W, BB, BZ, B, C, H)

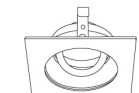

Square Adjustable Gimbal

ELK3329
Finishes:
(W, BB, BZ, B, C, H)

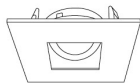

Square Adjustable Pinhole

ELK3327
Finishes:
(B, BB, BZ)

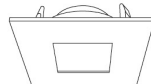

Square Reflector

ELK3341
Finishes:
(W, B, BB, BZ)

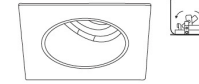

Square Adj. Wall Wash

ELK3322
Finishes:
(W)

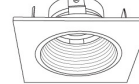

Square Adjustable Baffle

ELK3393
Finishes:
(W)

Compatible Products

For use with Dedicated 3" 0-10V Koto ICAD LED Housings

3" Pex™ Trimless Only for use with EL386/CDXA

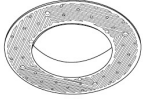

Spackle Frame

EL3SFR

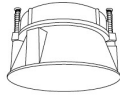

Adjustable Trimless Reflector

ELK315

Finishes:
(W, B, H)

3" Flush Mount Trim Adaptors

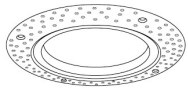

Round Flush Mount

EL3FMR

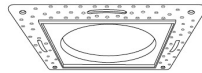

Square Flush Mount

EL3FMS

3" Accessories

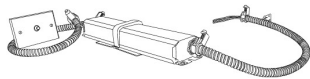

Emergency Battery Backup

CAT NO.	SPECIFICATIONS
KEM-LD5	8W, 120/277V

* Requires access from above



Fire Cover

CAT NO.	SPECIFICATIONS
FIRECVR	9 3/4" H x 17" O.D.

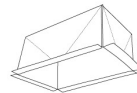

Fire Enclosure

CAT NO.	SPECIFICATIONS
FIREENCL	20 3/8" L x 14 3/8" W
FIREENCL-S	Shallow, 16" L x 14 3/8" W

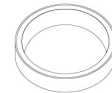

Mica Fire Tape

CAT NO.	SPECIFICATIONS
FIRETAPE	3/4" W x 16' L