

# 0-10V, 120/277V 4" New Construction IC Airtight Housing for 2-Hr Fire Rated Ceilings

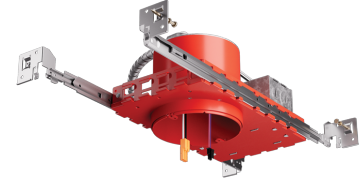

Maximum 2-Hour Fire Rated ceiling assembly can be maintained when installed according to the International Building Code, Section 714.

## Features

- New Construction IC Airtight Housing for **2-Hour Fire Rated ceilings**
- Junction Box with hanger bars with quick-connect for easy fixture installation
- Round opening for easy hole cutting
- Maximum 2-Hour Fire Rated ceiling assembly can be maintained when installed according to the International Building Code, Section 714
- Covered by U.S. Patents

## Specifications

<b>Voltage</b>	120/277V
<b>Dimmable</b>	0-10V

## Dimensions

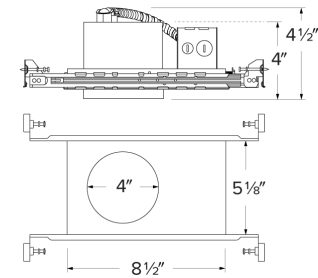

## Technical Details

**Installation:** Hanger bars that can be nailed to joists.

**Hanger Bars:** Hanger bars with True Nail for easy installation in regular lumber, engineered lumber, and laminated breams. Integral T-bar slots for easy installation in T-Bars. Hanger bars span 24". Score lines allow for tool-free hanger bar size reduction. Integral leveling flange allows for single-person installation while aligning housing with the joists.

### Listings:

- IC Rated for direct contact with insulation
- For 2-Hr Fire Rated ceilings
- cUL listed under cUL 514A Standards as a metallic outlet box

### Compatible With:

- 4" 0-10V DX Koto™ Fixtures, 0-10V LED Sky™ Panels, and 4" 0-10V LED Inserts (EL495 Series)

## Product Numbers

Item	Description	Voltage	Dimming
<b>EJB4ICDXA</b>	4" O.D. x 4 1/2" H	120/277V	0-10V
<b>EJB4ICDXA-EM</b>	Emergency Battery Backup	120/277V	0-10V

# Compatible Products

For use with 0-10V, 120/277V Housings for 2-Hour Fire Rated Ceilings

## 0-10V DX Koto™ LED Module

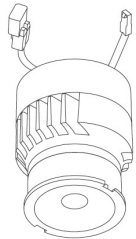

0-10V DX Koto™ LED Module  
ELK10DX

PRODUCT NUMBER BUILDER				
Koto™ LED Module	Lumens	Voltage	Color Temperature	Beam Angle
ELK	10 1000 lm	DX 120/277V	27 2700K 30 3000K 35 3500K 40 4000K SD Sunset (3000K to 1800K)	(blank) 38° lens (Standard) -S 18° lens -N 25° lens -W 60° lens

### ACCESSORIES



#### Lens

- EP731C 18° Lens
- EP732C 25° Lens
- EP733C 38° Lens
- EP734C 60° Lens

\*EP732C, EP733C, EP734C Included



#### Shoot

- L50W White
- L50B Black



#### Secondary Optics

- L45 Hex Louver (Black)
- L57 Hex Louver (White)
- L46 Linear Lens
- L47 Spread Louver
- L49 Frosted Lens
- L51 Color Shifter
- L52 Blue Optic Lens
- L53 Pink Optic Lens

## 4" Pex™ Twist-On Trims

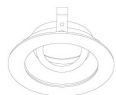

Adjustable Gimbal

ELK4129

Finishes:

(W, BB, BZ, B, C, H)



Adjustable Pinhole

ELK4127

Finishes:

(W, BB, BZ, B, H, CP)

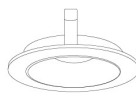

Shallow Reflector

ELK4116

Finishes:

(W, H)

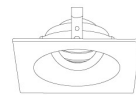

Adjustable Gimbal

ELK4229

Finishes:

(W, BB, BZ, B, C, H)

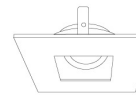

Adjustable Pinhole

ELK4227

Finishes:

(W, BB, BZ, B, N)

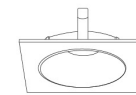

Shallow Reflector

ELK4216

Finishes:

(W, H)

## 4" Unique™ Twist-On Trims



Shallow Reflector

ELK4710

Finishes:

(W, B, BZ)

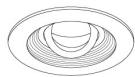

Shallow Baffle

ELK4713

Finishes:

(W, BZ)



Wall Wash

ELK4715

Finishes:

(W, BZ)



Adjustable Spot

ELK4188

Finishes:

(W, B, BZ)

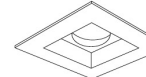

Square Reflector

ELK4714

Finishes:

(W, B, BZ)

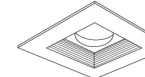

Square Baffle

ELK4716

Finishes:

(W, BZ)

## 4" Flush Mount Trim Adaptors



#### Round Adaptor

EL4FMR

- Compatible with ELK4116, ELK4127, ELK4129, ELK4710, ELK4713, ELK4715



#### Square Adaptor

EL4FMS

- Compatible with ELK4216, ELK4227, ELK4229,

\*Finishes: **W** - All White, **BB** - All Black, **BZ** - All Bronze, **B** - Black Reflector w/White Ring, **C** - Chrome Reflector w/White Ring, **H** - Haze Reflector w/White Ring

# Compatible Products

For use with 0-10V, 120/277V Housings for 2-Hour Fire Rated Ceilings

## 4" 120/277V, 0-10V LED Inserts



### Round Insert

**EL495**

Finishes:

(DW, DHW, DCW)

#### PRODUCT NUMBER BUILDER

4" 120/277V LED Inserts	Color Temperature	Finish
<b>EL495</b>		
	<b>30</b> 3000K (800 lm) <b>35</b> 3500K (850 lm) <b>40</b> 4000K (900 lm)	<b>DW</b> All White <b>DHW</b> Haze w/White Ring <b>DCW</b> Chrome w/White Ring

## 120/277V, 0-10V Round LED Sky Panels™

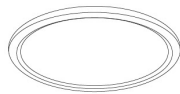

### 0-10V Round LED Sky Panel™

CAT NO.	SPECIFICATIONS
ELSP63DXCT3W	White, 6", 14W, 1000 lm, 3000K - 4000K
ELSP63DXCT3B	Black, 6", 14W, 1000 lm, 3000K - 4000K
ELSP83DXCT3W	White, 8", 17W, 1400 lm, 3000K - 4000K
ELSP83DXCT3B	Black, 8", 17W, 1400 lm, 3000K - 4000K