

### How to put Koto Sylo Track Head together:

**Step 1**

Un-Twist the front ring from Sylo track fixture

**Step 2**

Connect Koto LED Module to Sylo track fixture using quick connect system

**Step 3**

Twist front ring back to Sylo track fixture

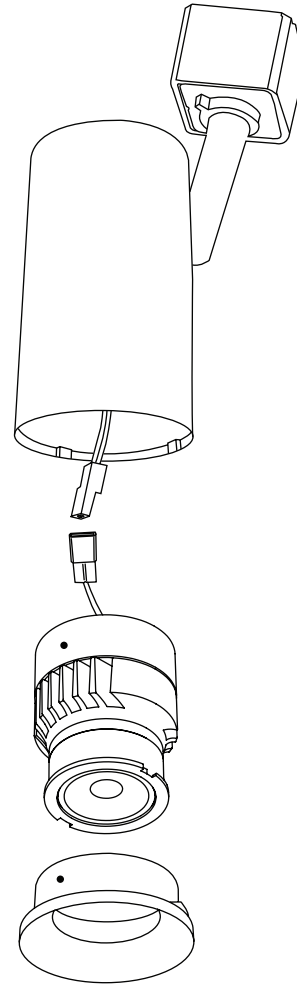

### Track Fixture Installation:

**CAUTION:** Disconnect power before installing.

To attach lampholder to the track, align the polarity lines of the track and the polarity lined of the lampholder. Push top portion of the adapter (with contact fingers) into the slot in the track and turn 90°. If the adapter does not turn easily, do not force, but turn in other direction. To remove, depress the release lever with the index finger and turn 90°.

