

**WARNING: FIRE/ELECTRICAL HAZARD**

This equipment is intended to be installed only by qualified personnel. The installation must be made in accordance with the current edition to the National Electric Code and all applicable state and local building codes. The final installation must be approved by the appropriate qualified electrical/building inspector(s). Improper installation may result in a fire or electrical hazard. Be sure the electrical power to the circuit has been disconnected before installing this electrical system.

**NOTE:** Model 803 and 804 are the same item, with the L and Straight fittings included in the box. Either one that is ordered will include both fittings to allow it to be used as a **Straight Connector** or as an **L Connector**.

**PACKAGE CONTENTS:**

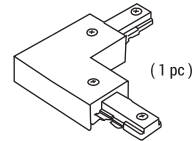

**L-Connector**  
(EP804) (EC804)

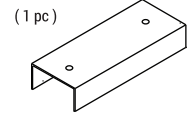

**Straight-Connector Cover**  
(EP803) (EC803)

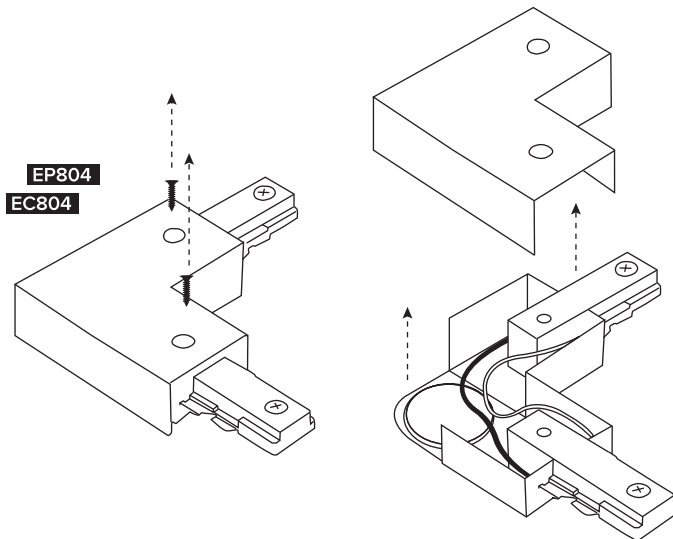

**STEP 1.** Unscrew (2) screws and removed top L-shaped cover.

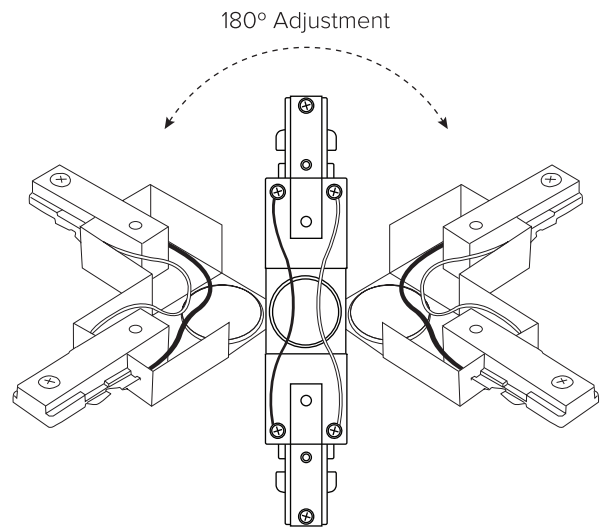

**STEP 2.** Manually adjust connector until is fully straight.

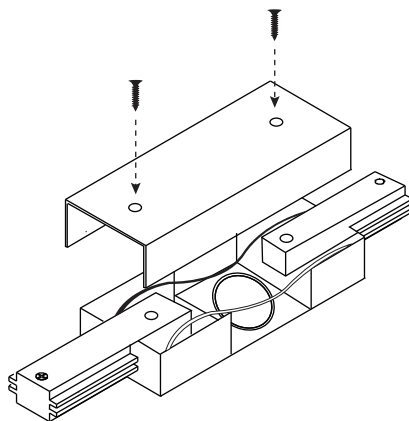

**STEP 3.** Screw straight shaped cover included

