

ELCO Lighting announces

The Maple System

5" LED Square Frame & Light Engines

- The perfect luminaire solution for commercial, hospitality and multi-story applications.
- Great for structures with shallow plenum spaces.
- Can be installed in residential wood structures or commercial building drop ceilings.

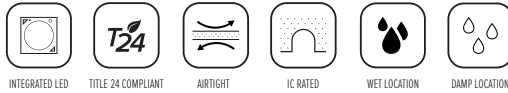
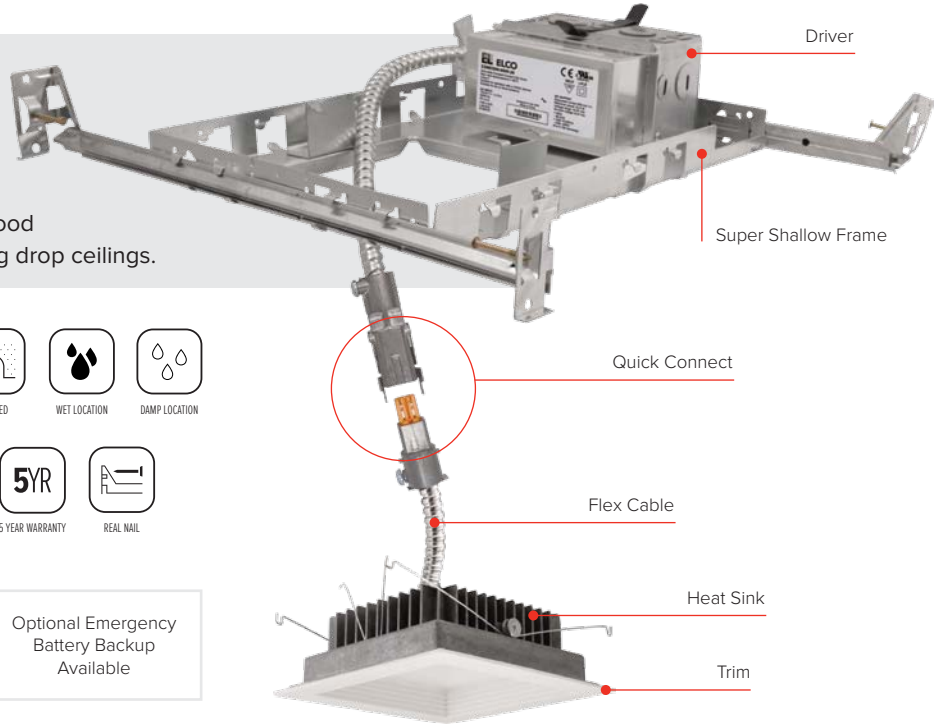

APPLICATIONS

STYLES

FINISHES

LUMENS

COLOR TEMPERATURE

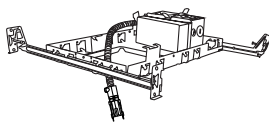

IC Shallow Frame
or
Non-IC Shallow Frame

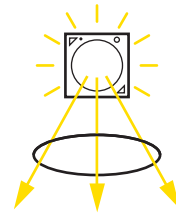
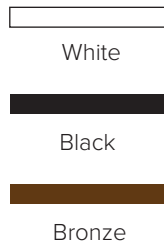
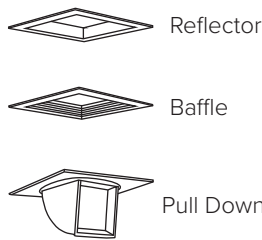

1100 lm to 2000 lm



3000K to 4000K

Check out our full line of Catalogs at elcolighting.com



LED Undercabinet



Track Fixtures Brochure



The Elm System



The Laurel System



LED Housings & Inserts



Slope Ceiling Recessed Fixtures



LED Wall Packs & Floodlights



The Maple System

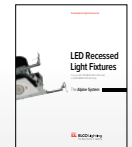

The Alpine System



ELCO Lighting
The Best Choice in Lighting

2042 E. Vernon Ave.
Vernon, CA 90058
Tel. 323.231.2600
elcolighting.com