

Pex™

3" Round Adjustable Reflector Wall Wash

Pex™ precision die-cast adjustable trims with Twist-On system for easy Koto™ Module installation



Features

- 3" Round Adjustable Reflector Wall Wash.
- 45° Adjustability
- 4 3/8" O.D.
- Convenient twist-on design for easy installation.
- Damp Location Rated.
- Lamp: Koto™ LED Module.
- Recommended to be used with Maximum Adjustability Housings

Technical Details

Construction: Diecast aluminum with a powder coated finish.

Installation: Twist-on design allows for easy mounting onto the Koto™ LED Module.

Lamp: Koto™ LED Module.

Dimensions

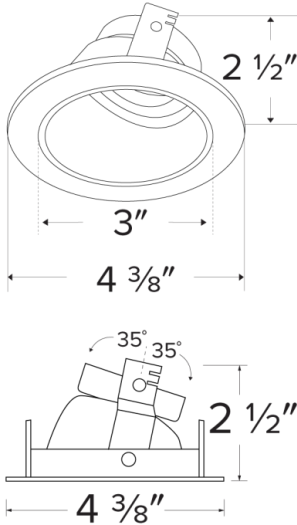

Product Numbers

Item	Finish
ELK3622W	All White

Product Number Builder

Example: ELK3622W

Pex™ 3" Round Adjustable Reflector Wall Wash

Finish

ELK3622

W All White

Compatible Products

For use with 3" Koto™ Twist-On Trims



Koto™ LED Module & 3" Dedicated LED ICA Housing

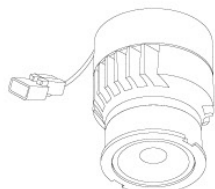

Koto™ LED Module
ELK07 - ELK09

PRODUCT NUMBER BUILDER				
Koto™ LED Module	Lumens	Color Temperature	Beam Angle	
ELK				
07	750 lm	27	2700K	(blank) 38° lens (Standard)
09	950 lm	30	3000K	-S 18° lens
		35	3500K	-N 25° lens
		40	4000K	-W 60° lens
		SD	Sunset Dimming (ELK09 Only)	



3" ICA Maximum Adjustability Housing
New Construction

CAT NO.	SPECIFICATIONS
EL386ICA	Maximum Adjustability

Koto™ Architectural LED Light Engine & 3" Architectural ICA Housings

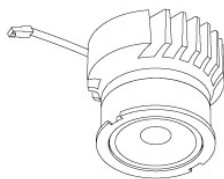

Koto™ LED Light Engine
ELK19 - ELK21

PRODUCT NUMBER BUILDER				
Koto™ LED Light Engine	Lumens	Color Temperature	Beam Angle	
ELK				
19	750 - 850 lm	27D	2700K	(blank) 38° lens (Standard)
21	1100 - 1500 lm	30D	3000K	-S 18° lens
		35D	3500K	-N 25° lens
		40D	4000K	-W 60° lens
		SD	Sunset Dimming (ELK19 Only)	



3" High Lumen Maximum Adjustability ICA Housing
1500 lm (18.9W) w/ELK21 Series Module
Not for use with ELK19 Series Module

New Construction

CAT NO.	SPECIFICATIONS
E3LK85ICAD	120/277V - 0-10V/Triac/ELV

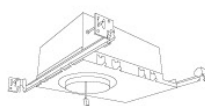

3" Shallow Maximum Adjustability ICA Housing
850 lm (14.7W) w/ELK19 Series Module
1100 lm (14.7W) w/ELK21 Series Module

New Construction

CAT NO.	SPECIFICATIONS
E3LK76ICA	120V - Triac/ELV
E3LK77ICAD	120/277V - 0-10V/Triac/ELV

ACCESSORIES FOR KOTO™ LED MODULE & KOTO™ ARCHITECTURAL LED LIGHT ENGINE



Lens

EP731C	18° Lens
EP732C	25° Lens
EP733C	38° Lens
EP734C	60° Lens

*EP732C, EP733C, EP734C Included



Reflectors

EP735C	15°
EP736C	25°
EP737C	38°
EP738C	60°



Secondary Optics

L45	Hex Louver	L51	Color Shifter
L46	Linear Louver	L57	White Hex Louver
L47	Spread Louver	L52	Blue Lens
L49	Frosted Lens	L53	Pink Shifter



Snoot

L50W	White
L50B	Black

Compatible Products

For use with 3" Koto™ Twist-On Trims



Koto™ 24V DC LED Light Engine

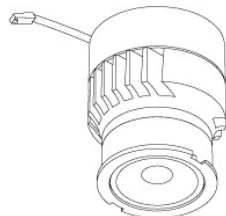

24V DC Koto™ LED
Light Engine

PRODUCT NUMBER BUILDER				
Koto™ LED Light Engine	Lumens	Color Temperature		Voltage
ELK				
	08 800 lm	27 2700K		-24 24V DC
		30 3000K		

**Standard module includes 38° installed with 25° & 60° field changeable lenses.*

ACCESSORIES



Lens

EP731C 18° Lens
EP732C 25° Lens
EP733C 38° Lens
EP734C 60° Lens

**EP732C, EP733C, EP734C
Included with standard module*



Snoot

L50W White
L50B Black



Secondary Optics

L45 Hex Louver
L46 Linear Lens
L47 Spread Louver
L49 Frosted Lens
L51 Color Shifter
L57 White Hex Louver
L52 Blue Lens
L53 Pink Shifter

3" Koto™ Dedicated LED ICA Housings (24V DC Input)

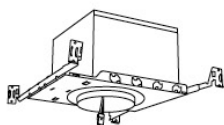

24V DC 3" ICA Maximum Adjustability Housing
New Construction

CAT NO.	SPECIFICATIONS
E24V386ICA	Maximum Adjustability

**Requires 24V DC Transformer*