

# 8" New Construction LED IC Housing

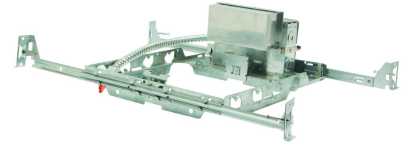

## Features

- Frame with driver for IC New Construction to be used with 8" LED Insert.
- High efficiency driver mounted on J-Box.
- cUL listed for damp location and for feed through.
- Meets restricted airflow requirements (Per ASTM E-283).
- CA Title 24 compliant.

## Specifications

<b>Wattage</b>	19W
<b>Voltage</b>	120/277V
<b>Dimmable</b>	0-10V
<b>Damp Location</b>	Listed

## Dimensions

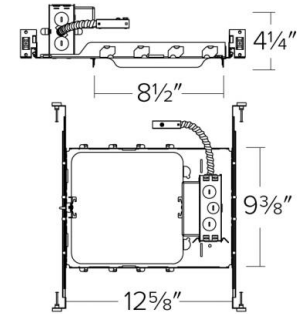

## Technical Details

### Construction:

- IC Rated for Direct Contact with Insulation.
- Stamped galvanized steel frame.

### Installation:

- Designed for ceiling plenums where 2x6 joists or taller are used.
- Suitable for T-grid and drop ceiling applications.
- Driver mounted on junction box for cooler LED operation.

**Junction Box:** 16 gauge pre-wired galvanized steel Junction Box, 25 cubic-inch for a maximum of (8) #12 AWG wires. Positioned to accommodate straight conduit runs. Furnished with seven 1/2" trade size conduit pry-out knockouts, four 3/4" pry-out knockouts, one 1" pry-out knockout and (4) Romex pry-outs with strain relief. Strain clamps to install or remove covers for easy access and grounding.

**Hanger Bars:** Pre Installed high strength hanger bars with True Nail easy installation in regular lumber, engineered lumber, and Laminated Beams. Integral T-Bar slots for easy installation in T-Bars. Spans up 24" and can be repositioned 90°. Score lines allow for tool-free hanger bar size reduction. Integral leveling flange allows for single-person installation while easily aligning the housings with the joists.

### Electrical:

- Driver is rated for 120/277V.
- High efficiency, high power factor > 0.9 driver.

### Dimmability:

- Flicker-Free Dimming.
- For full list of dimmers refer to the Dimmer Compatibility List.

**Listings:** cUL/cUL Listed for Damp Location. Listed for Direct Contact with Insulation and Combustible Material; Listed for Feed Through. Inserts meet restricted air flow requirements (Per ASTM E-283).

**Warranty:** ELCO Products are built to last. 5-year Limited warranty.

## Product Numbers

Item	Watts	Voltage	Dimming
<b>E8SQLFU15</b>	19W	120/277V	0-10V

# Compatible Products

For use with 8" Square New Construction IC Housing



## 8" Square LED Retrofit Insert

---

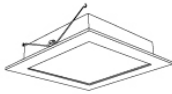

Square LED Insert

CAT NO.	SPECIFICATIONS
E822L1530W	19W, 1460 lm, 3000K