

6" Cedar System Remodel IC Airtight Housing w/Driver

IC Airtight remodel housing for residential and light commercial, 850 to 1250 lumens.



Features

- cUL Listed for direct contact with insulation.
- Optional 90 minutes, 120/277 VAC, 60Hz, Emergency Backup.
- Meets Title 24 requirements.
- Flicker-Free Dimming.
- USA designed and assembled.
- Limited 5 year warranty.
- For use with ELCO Cedar™ System 6" LED Light Engines.
- 2 at the end of the item number denotes Generation 2. Please note Gen 2 and Gen 1 are not cross compatible.

Specifications

Lumens	850 lm - 1250 lm
Voltage	120/277V or 120V
Dimmable	Triac/ELV, Triac/ELV/0-10V, Sunset
Power Factor	≥0.95
Damp Location Listed	

Dimensions

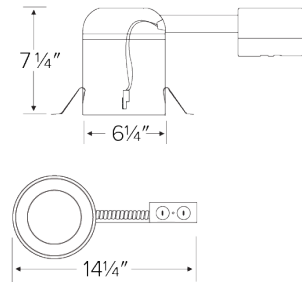

Technical Details

Construction:

- Single wall IC rated for direct contact with insulation. For use in IC and non-IC conditions. Up to 1250 lumens.
- Airtight housing with gasket to restrict airflow in accordance with ASTM E-283 air-tight requirements.

Installation:

- Designed for ceiling plenums where 2x8 joists or taller are used.
- Suitable for T-grid and drop ceiling applications.
- See installation sheet for detailed information.

Junction Box: Positioned to accommodate straight conduit runs. Two 3/4" knockouts, Seven 1/2" trade size conduit knockouts, One 3/8" knockout. Four Pry-out knockout slots for easy romex installation.

Electrical:

- Driver is rated for 120V and 277V input (120/277V).
- High Efficiency driver with a power factor > 0.95.

Dimmability:

- 3 in 1 dimming: Triac, ELV and 0-10V dimming in one driver.
- 0-10V dimming down to 5% with a compatible dimmer.
- Can be specified with Lutron drivers for 0.1% and 1% dimming.
- For a full list of dimmers refer to the Dimmer Compatibility List.

Listings: cUL Listed for Damp Location and for Wet Location with select trims. cUL Listed for Direct Contact with Insulation and Combustible Material. cUL Listed for Feed Through.

Product Numbers

Item	Lumens	Voltage	Dimming
E6LRC08ICA2	850 lm	120V	Triac/ELV
E6LRC08ICAD2	850 lm	120/277V	Triac/ELV/0-10V
E6LRC08ICASD	850 lm	120/277V	Sunset
E6LRC12ICA2	1250 lm	120V	Triac/ELV
E6LRC12ICAD2	1250 lm	120/277V	Triac/ELV/0-10V
E6LRC12ICASD	1250 lm	120/277V	Sunset

Product Number Builder

Example: **E6LRC08ICA2**

ELCO Cedar 6" Housing	Lumens	IC Airtight	Dimming	Generation	Optional
E6LRC	08 850 lm 12 1250 lm	ICA ICA	120V Triac/ELV D 120/277V Triac/ELV/0-10V SD Sunset L Lutron	2 Gen 2 Gen 1	No EM EM1 Emer. Backup up to 700 lm EM2 Emer. Backup to 1100 lm

Compatible Products

For use with 6" Cedar™ IC LED housings

6" Cedar™ LED Light Engines



Round Reflector Trim

E610C
Finishes:
(W, B, BZ, C, G, H)



Round Drop Glass Reflector Trim

E612C
Finishes:
(W, B, BZ, C, G, H)



Round Baffle Trim

E614C
Finishes:
(W, B, BZ, BB)



Round Adjustable Baffle Trim

E616C
Finishes:
(W, B, BZ)



Round Adjustable Reflector Trim

E617C
Finishes:
(W, B, BZ, C, H)

PRODUCT NUMBER BUILDER

6" Cedar™ Trim	Style	Lumen	Color Temperature	Finish
E6				
	10C Reflector	08 850 lm (8.76W)	27 2700K	W All White
	12C Drop Glass	12 1250 lm (12.88W)	30 3000K	B Black w/White Ring
	14C Baffle		35 3500K	BZ All Bronze
	16C Adjustable Baffle		40 4000K	BB All Black
	17C Adjustable Reflector		50 5000K	C Chrome w/White Ring
			SD Sunset Dimming	G Gold w/White Ring
				H Haze w/White Ring

6" Accessories



Fire Cover

CAT NO.	SPECIFICATIONS
FIRECVR	9 3/4" H x 17" O.D.



Fire Enclosure

CAT NO.	SPECIFICATIONS
FIREENCL	20 3/8" L x 14 3/8" W
FIREENCL-S	Shallow, 16" L x 14 3/8" W



Mica Fire Tape

CAT NO.	SPECIFICATIONS
FIRETAPE	3/4" W x 16' L