

5" Sloped Adjustable Gimbal Ring with Reflector

ELCO Slant allows for installation in sloped ceilings ranging from 2/12 (10°) to 12/12 (45°). Can be used in insulated ceilings. Fits in 2" x 8" joist construction.



Features

- Adjustable Gimbal with Reflector and White Metal Trim Ring.
- Lamp: 75W MAX PAR30 or LED.
- O.D.: 7 1/4".

Technical Details

Construction:

- Meticulously manufactured trim with a powder coated or anodized finish.
- Integral gimbal ring holds lamp and allows for 35° internal adjustability while keeping a flush look on the ceiling.
- Diecast trim ring for durability and lasting quality.

Installation: Clips securely mount trim into the housing and keeps ring flush with ceiling.

Compatible Housing: Compatible with EL518ICA & EL518RICA.

Lamp: Compatible with Medium base (E26) PAR type.

Options



White



Black

Product Numbers

Item	Finish
EL577B-OM5W	All Black
EL577W-OM5W	All White

Product Number Builder Example: EL577B-OM5W

5" Adjustable Gimbal with Reflector

Finish

White Metal Trim Ring

EL577

B All Black
W All White

-OM5W

Compatible Products

For use with **5" Sloped Trims**

5" E26 Base Sloped Ceiling IC Housings



5" E26 Medium Base Sloped Housing
New Construction

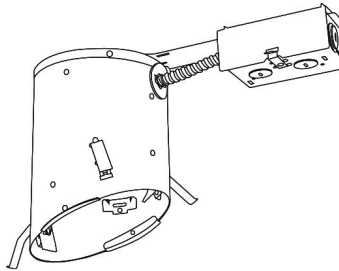

5" E26 Medium Base Sloped Housing
Remodel

CAT NO.	SPECIFICATIONS
EL518ICA	75W Max.

CAT NO.	SPECIFICATIONS
EL518RICA	75W Max.