

4" Trimless Cedar System New Construction IC Airtight Housing w/Driver

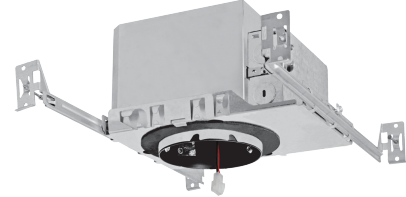

IC Airtight housing for trimless, high-end residential and light commercial, 850-1600 lumens.

Features

- cUL Listed for direct contact with insulation.
- Compatible with 2 x 8 construction.
- Optional 90 minutes, 120/277 VAC, 60Hz, Emergency Backup.
- Flicker-Free Dimming.
- USA designed and assembled.
- Limited 5 year warranty.
- For use with ELCO Cedar™ System 4" Trimless LED Light Engines.
- 2 at the end of the item number denotes Generation 2. Please note Gen 2 and Gen 1 are not cross compatible.

Specifications

Wattage	12.5 MAXW
Dimmable	Triac/ELV/0-10V
Power Factor	≥0.95
Damp Location	Listed

E4TL08ICA Dimensions

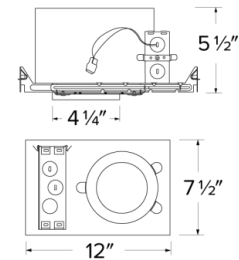

Technical Details

Construction:

- For use in IC and non-IC conditions. Up to 1600 lumens.
- Housing adjusts in frame to accommodate up to 1 1/2" ceiling thickness.
- Airtight housing with gasket to restrict airflow in accordance with ASTM E-283 air-tight requirements.

Installation:

- Designed for ceiling plenums where 2x6 joists or taller are used.
- High strength hanger bars can easily be nailed to joists.
- Suitable for T-grid and drop ceiling applications.
- See installation sheet for detailed information.

Junction Box: Positioned to accommodate straight conduit runs. Two 3/4" knockouts, Seven 1/2" trade size conduit knockouts, One 3/8" knockout. Four Pry-out knockout slots for easy romex installation.

Hanger Bars: Pre Installed hanger bars with True Nail easy installation in regular lumber, engineered lumber, and Laminated Beams. Integral T-bar slots for easy installation in T-Bars. Spans up 24" and can be repositioned 90°. Score lines allow for tool-free hanger bar size reduction. Integral leveling flange allows for single-person installation while easily aligning the housings with the joists.

Electrical:

- Driver is rated for 120V and 277V input (120/277V).
- High Efficiency driver with a power factor > 0.95.

Emergency Battery Pack: Optional 90 minute battery pack available with test indicator switch. Note that double wall housings require Access From Above Ceiling for Battery Maintenance.

Dimmability:

- 3 in 1 dimming: Triac, ELV and 0-10V dimming in one driver.
- 0-10V dimming down to 5% with a compatible dimmer.
- Can be specified with Lutron drivers for 0.1% and 1% dimming.
- For a full list of dimmers refer to the Dimmer Compatibility List.

Listings: cUL Listed for Damp Location and for Wet Location with select trims. cUL Listed for Direct Contact with Insulation and Combustible Material. cUL Listed for Feed Through.

E4TL16ICA Dimensions

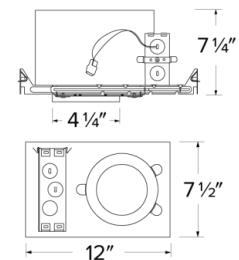

Product Number

Item	Description	Watts	Dimming
E4TL08ICAD2EM7	Emergency Battery Backup	12.5 MAX	Triac/ELV/0-10V

Product Number Builder

Example: **E4TL08ICA2**

ELCO Cedar 4"
Trimless Housing

E4TL

Lumens

- 08** 850 lm
- 12** 1250 lm
- 16** 1600

IC Airtight

ICA ICA

Dimming

- 120V Triac/ELV
- D** Triac/ELV/0-10V
- SD** Sunset
- L** Lutron

Generation

- 2** Gen 2
- Gen 1

Optional

- No EM
- EM1** Emer. Backup up to 700 lm
- EM2** Emer. Backup to 1100 lm
- EM7** Emer. Backup 12.5W MAX

Compatible Products

For use with 4" Cedar™ Trimless IC LED housings with Driver

4" Cedar™ Trimless LED Light Engines



Round Reflector Trim

E430C
Finishes:
(W, B, BZ)



Round Baffle Trim

E434C
Finishes:
(W, B, BZ)



Square Reflector Trim

E444C
Finishes:
(W, B, BZ)

PRODUCT NUMBER BUILDER				
4" Cedar™ Trimless	Style	Lumen	Color Temperature	Finish
E4				
	30C Round Reflector	08 850 lm	27 2700K	W All White
	34C Round Baffle	12 1250 lm (Round only)	30 3000K	B All Black
	44C Square Reflector	16 1600 lm (Round only)	35 3500K	BZ All Bronze
			40 4000K	
			50 5000K	
			SD Sunset Dimming	

4" Cedar™ Trimless Accessories



Fire Cover

CAT NO.	SPECIFICATIONS
FIRECVR	9 3/4" H x 17" O.D.



Fire Enclosure

CAT NO.	SPECIFICATIONS
FIREENCL	20 3/8" L x 14 3/8" W
FIREENCL-S	Shallow, 16" L x 14 3/8" W



Mica Fire Tape

CAT NO.	SPECIFICATIONS
FIRETAPE	3/4" W x 16' L