

4" IC Remodel Housing with Adjustable Lamp Holder



Features

- Single Wall Remodel Airtight IC construction, for use in insulated ceilings.
- Adjustable socket bracket allows the use of different lamp types and sizes as well as proper and consistent positioning.
- Four remodel clips secure housing and accommodate various ceiling thickness.
- Adjustable socket bracket allows for different lamp types/sizes and proper and consistent lamp positioning.
- Pre-wired junction box provided with 1/2" and 3/4" knockouts and with removable access plates.
- Trims sold separately.
- Lamp: 50W MAX, 120V, PAR20/R20 (not included),
- E26 Edison base socket for incandescent or LED lamps.
- CA Title 24 compliant (as low efficiency luminaire).
- cUL listed for damp location and for feed through.

Specifications

Wattage	50W
Voltage	120V
Lamp Type	Medium Base (E26)
Damp Location	Listed

Dimensions

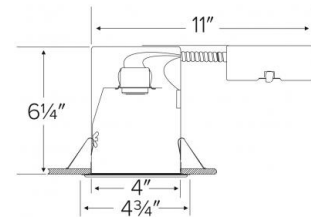

Technical Details

Construction:

- IC rated for direct contact with insulation, for use in IC or non-IC conditions.
- Housing adjusts in frame to accommodate up to 1 1/4" ceiling thickness.
- Airtight housing with gasket to restrict airflow in accordance with ASTM E-283 air-tight requirements.
- Aluminum housing for greater heat dissipation.

Installation: Designed for ceiling plenums where 2x8 joists or taller are used. Maximum hole cutout is 4 1/4". See installation sheet for detailed information.

Electrical:

- Input Voltage: 120V AC.
- Thermally protected against improper lamping.

Trims: Compatible with ELCO 4" Line Voltage PAR trims.

Lamp: Designed for use with Medium Base (E26) PAR lamps up to 50W.

Listings:

- cUL Listed for Damp Location.
- cUL Listed for Feed Through.
- cUL Listed for Direct Contact with Insulation and Combustible Material.
- Airtight per ASTM E-283.
- Install a JA8-2016-E lamp/luminaire for Title 24 Compliance.

Warranty: ELCO Lighting warrants products will be free from defects in materials and workmanship for a period of 3 years.

Product Numbers

Item	Lamp type	Watts	Voltage
EL99RICA	Medium Base (E26)	50W	120V

