

# 4" IC Airtight Remodel Housing for Architectural Koto™ LED Engine



## Features

- IC Airtight for direct contact with insulation.
- Koto™ Architectural Housing: 120/277V 0-10V/Triac/ELV or 120V Triac/ELV with optional Emergency Battery Backup.
- Must be used with Architectural Koto™ LED Light Engines (ELK19, ELK21, or ELK24 Series).
- Lumen output based on module

## Specifications

<b>Wattage</b>	11.8W
<b>Lumens</b>	750 (ELK19) - 950 (ELK21) - 1100 (ELK24) lm
<b>Voltage</b>	120/277V or 120V
<b>Dimmable</b>	Triac/ELV, 0-10V/Triac/ELV

## Dimensions

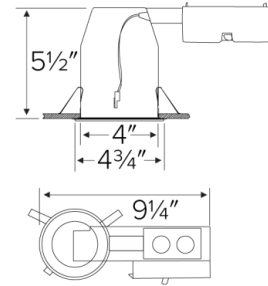

## Technical Details

**Lamp:** Designed for use with ELCO Architectural Koto™ LED Light Engines (ELK19, ELK21, or ELK24 Series).

### Construction:

- Single Wall IC Rated for direct contact with insulation, for use in IC or non-IC conditions.
- Housing adjusts in frame to accommodate up to 1 1/2" ceiling thickness.
- Airtight housing with gasket to restrict airflow in accordance with ASTM E-283 air-tight requirements.
- Steel housing for greater heat dissipation. Stamped galvanized steel frame.

**Installation:** Designed for ceiling plenums where 2x6 joists or taller joists are used. Maximum hole cutout is 4 1/4". See installation sheet for detailed information.

**Junction Box:** Positioned to accommodate straight conduit runs. Seven 1/2" trade size conduit knockouts, four 3/4" knockouts. Pry-out knockout slots. 4 Romex pryouts with strain relief.

### Electrical:

- Input Voltage: 120V .
- Inherently protected.

### Dimmability:

- Dimmability based on lamp.

### Listings:

- cUL Listed for Damp Location.
- cUL Listed for Wet Location with select trims.
- cUL Listed for Feed Through.
- cUL Listed for Direct Contact with Insulation and Combustible Material.
- Airtight per ASTM E-283.
- Install a JA8-2016-E lamp/luminaire for Title 24 Compliance.

**Warranty:** ELCO Lighting warrants products will be free from defects in materials and workmanship for a period of 3 years.

## Product Numbers

Item	Description	Lumens	Watts	Voltage	Dimming
E4LK87RICA	Remodel	750 (ELK19) - 950 (ELK21) - 1100 (ELK24) lm	11.8W	120V	Triac/ELV
		750 (ELK19) - 950 (ELK21) - 1100 (ELK24) lm			
E4LK88RICAD	Remodel	750 (ELK19) - 950 (ELK21) - 1100 (ELK24) lm	11.8W	120/277V	0-10V/Triac/ELV

# Product Number Builder

Example: **E4LK87RICA**

4" Koto™ Standard ICA Remodel Housing

Voltage

Dimming

**E4LK**

**87** 120V <sup>1</sup>

**88** 120/277V <sup>2</sup>

**RICA** Triac/ELV

**RICAD** 0-10V/Triac/ELV

<sup>1</sup> Available as 120V, Triac/ELV only

<sup>2</sup> Available as 120/277V, 0-10V/Triac/ELV only

# Compatible Products

For use with Dedicated 4" Architectural ICA LED Housings



## Koto™ Architectural LED Light Engine

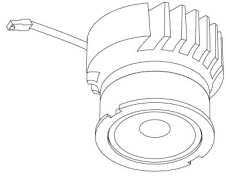

**Koto™ LED Light Engine**  
ELK19 - ELK21

PRODUCT NUMBER BUILDER			
Koto™ LED Light Engine	Lumens	Color Temperature	Beam Angle
ELK			
19	750 - 850 lm <sup>1</sup>	27D 2700K	(blank) 38° lens (Standard)
21	1100 - 1500 lm <sup>1</sup>	30D 3000K	-S 18° lens
24	1100 - 1800 lm <sup>1</sup>	35D 3500K	-N 25° lens
		40D 4000K	-W 60° lens
		SD Sunset Dimming (ELK19 Only)	-FC 18° - 50° Adjustable (ELK21 Only)

<sup>1</sup>Wattage based on housing.

### ACCESSORIES



#### Lens

EP731C	18° Lens
EP732C	25° Lens
EP733C	38° Lens
EP734C	60° Lens

<sup>\*</sup>EP732C, EP733C, EP734C Included



#### Snoot

L50W	White
L50B	Black



#### Secondary Optics

L45	Hex Louver
L46	Linear Lens
L47	Spread Louver
L49	Frosted Lens
L51	Color Shifter

## Koto™ FOCUS Architectural LED Light Engine

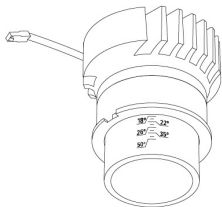

**Koto™ FOCUS LED Light Engine**

PRODUCT NUMBER BUILDER			
Koto™ FOCUS LED Light Engine	Lumens	Color Temperature	Beam Angle
ELK			
21	1100 - 1500 lm	27D 2700K	-FC 18° - 50° Adjustable Focus
		30D 3000K	
		35D 3500K	
		40D 4000K	

<sup>1</sup>Wattage based on housing.

## 4" Pex™ Twist-On Trims

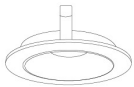

**Shallow Reflector**

ELK4116  
Finishes:  
(W, H)



**Reflector**

ELK4118  
Finishes:  
(W, BB, BZ, B, C, H)



**Adjustable Gimbal**

ELK4129  
Finishes:  
(W, BB, BZ, B, C, H)



**Adjustable Pinhole**

ELK4127  
Finishes:  
(W, B, BB, BZ, N, CP)



**Adjustable Baffle**

ELK4193  
Finishes:  
(W, BB, B)



**Rotatable Slot Aperture**

ELK4120  
Finishes:  
(W)



**Slot Aperture**

ELK4130  
Finishes:  
(W)



**Adjustable Spot**

ELK4188  
Finishes:  
(W, B, BZ)

# Compatible Products



For use with Dedicated 4" Architectural ICA LED Housings & ALO™ Box

## 4" Pex™ Twist-On Trims



**Shallow Reflector**

**ELK4216**  
Finishes:  
(W, H)



**Reflector**

**ELK4218**  
Finishes:  
(W, BB, BZ, B, C, H)



**Adjustable Gimbal**

**ELK4229**  
Finishes:  
(W, BB, BZ, B, C, H)

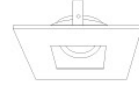

**Adjustable Pinhole**

**ELK4227**  
Finishes:  
(W, B, BB, BZ, N)

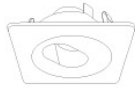

**Adjustable Slot Rotatable**

**ELK4220**  
Finishes:  
(W)



**Adjustable Phenolic Baffle**

**ELK4293**  
Finishes:  
(W, BB, B)

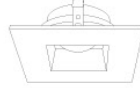

**Adjustable Reflector**

**ELK4282**  
Finishes:  
(W, BZ)

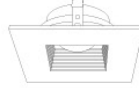

**Adjustable Baffle**

**ELK4284**  
Finishes:  
(W, B, BZ)

\*Finishes: **W** - All White, **BB** - All Black, **BZ** - All Bronze, **B** - Black Reflector w/White Ring, **C** - Chrome Reflector w/White Ring, **H** - Haze Reflector w/White Ring

## 4" Flexa™ Twist-On Trims



**Round Reflector**

**ELK4721**  
Finishes:  
(WW, BB, BZBZ, BW, CC, CW, HW, CN)



**Round Baffle**

**ELK4723**  
Finishes:  
(WW, BB, BZBZ, BW)

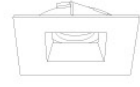

**Square Reflector**

**ELK4741**  
Finishes:  
(WW, BB, BZBZ, BW, HW)  
*\*Not for Remodel Housing*

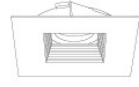

**Square Baffle**

**ELK4743**  
Finishes:  
(WW, BB, BZBZ, BW)  
*\*Not for Remodel Housing*



**Adjustable Sq. Reflector**

**ELK4759**  
Finishes:  
(WW, BB, B, H)

\*Finishes: **W** - All White, **BB** - All Black, **BZ** - All Bronze, **B** - Black Reflector w/White Ring, **C** - Chrome Reflector w/White Ring, **H** - Haze Reflector w/White Ring