

4" Die-cast Deep Round Reflector Trim for PAR LAMPS



4" die-cast deep round reflector trim. For use with PAR Lamps.

Features

- 4" Deep Round Reflector
- Lamp: For use with PAR Lamps.

Technical Details

Construction: Diecast aluminum with a powder-coated finish.

Compatible Housing: Compatible with 4" IC and Non-IC Housings (non-shallow).

Lamp: For use with PAR Lamps.

Options



White



Bronze

Dimensions

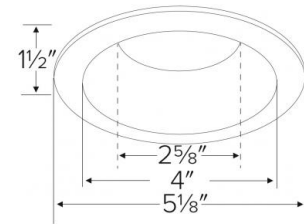

Product Number

| Item | Finish |
|-----------|------------|
| ELL4817BZ | All Bronze |

Product Number Builder Example: ELL4817W

4" Round Deep Reflector Trim

Finish

ELL4817

- W** All White
- BZ** All Bronze

Compatible Products

For use with 4" Trims for PAR Lamps

4" Line Voltage ICA Housings



4" Airtight IC Housing
Double Wall Construction

| CAT NO. | SPECIFICATIONS |
|---------|----------------|
| EL99ICA | Lamp: 50W MAX. |



4" Airtight Housing
New Construction

| CAT NO. | SPECIFICATIONS |
|---------|----------------|
| EL99A | Lamp: 50W MAX. |



4" Airtight IC Housing
New Construction

| CAT NO. | SPECIFICATIONS |
|-----------|--------------------|
| EL99LDICA | Lamp: LED 12W MAX. |



4" Airtight IC Housing with GU24 Base Socket
New Construction

| CAT NO. | SPECIFICATIONS |
|-------------|----------------|
| EL99ICA-G24 | Lamp: 18W MAX. |



4" Airtight IC 2-Hour Fire Rated Housing
New Construction

| CAT NO. | SPECIFICATIONS |
|----------|----------------|
| EL99FICA | Lamp: 35W MAX. |

4" Accessories



Fire Cover

| CAT NO. | SPECIFICATIONS |
|---------|---------------------|
| FIRECVR | 9 3/4" H x 17" O.D. |

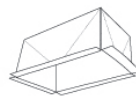

Fire Enclosure

| CAT NO. | SPECIFICATIONS |
|------------|----------------------------|
| FIREENCL | 20 3/8" L x 14 3/8" W |
| FIREENCL-S | Shallow, 16" L x 14 3/8" W |



Mica Fire Tape

| CAT NO. | SPECIFICATIONS |
|----------|----------------|
| FIRETAPE | 3/4" W x 16' L |