

3" Koto Sylo™ Monopoint



Features

- Modern Monopoint Die-Cast aluminum fixture for easy maintenance and upgrades
- Standard Fixtures or Fixtures with Stems (12", 24", 36", 48", and 60") available
- Includes Standard 38° lens, with 25° and 60° lenses. Optional: 15°, 18°, 90° lenses available
- Fits 3 ½" and 4" Octagon and Round Junction boxes
- Sunset option dims from 3000K to 1800K
- Human Centric option dims from 4000K to 2200K
- 90° tilt, 358° rotation
- Energy Star Certified. Title 24 JA8-2019 Compliant
- Life span of 50,000 hours L70

Specifications

Wattage	5W - 14.7W
Lumens	350 lm - 1500 lm
Voltage	120/277V or 120V
Color Temp.	2400KK - SunsetK
Dimmable	Triac/ELV, 0-10V/Triac/ELV (1% Dimming)
Lamp Type	LED
Beam Angle	38°
CRI	95+
Damp Location	cUL Listed

Options



All White



All Black



All Silver

Technical Details

Optics: Polycarbonate module lens diffuses light evenly throughout while reducing glare with LED technology.

Construction: Integrated driver and light engine with quick connect. Diecast aluminum body with heat fins allows for efficient cooling.

Installation: Twist-on design for toolless module installation.

Electrical: Module connects to 120V power supply. High-efficiency driver with a power factor >0.9. Start time of less than 0.75 seconds.

LED Technology: Extremely accurate Color Rendering Index of 95+. Lumen Maintenance of 50,000 hours L70 Life based on LM80 standardized test results. Superior Thermal Management by utilizing integrated heat sink. Instant On to Full Brightness technology. No LED pixelation.

Delivered Lumens:

0327 2700K/442.8 lm/5W **0330** 3000K/461.2 lm/5W

0727 2700K/770 lm/10.5W **0730** 3000K/800 lm/10.5W **0735** 3500K/830 lm/10.5W **0740** 4000K/860 lm/10.5W

08CT5 2700K/728.5 lm/10.5W **08CT5** 3000K/886 lm/10.5W **08CT5** 3500K/902 lm/10.5W
08CT5 4000K/920 lm/10.5W **08CT5** 5000K/931 lm/10.5W

0927 2700K/912 lm/10.5W **0930** 3000K/950 lm/10.5W **0935** 3500K/990 lm/10.5W **0940** 4000K/1030 lm/10.5W **09SD** Sunset/940 lm/10.5W

10CT5 2700K/908 lm/12.5W **10CT5** 3000K/1012 lm/12.5W **10CT5** 3500K/1038 lm/12.5W

Dimensions

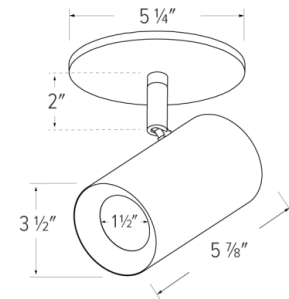

Dimensions with Stem

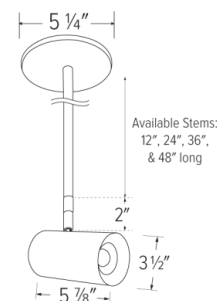

10CT5 4000K/1040 lm/12.5W **10CT5** 5000K/1032 lm/12.5W

1124 2400K/730 lm/12.5W **1127** 2700K/1068 lm/12.5W **1130** 3000K/1112 lm/12.5 **1135** 3500K/1156 lm/12.5W **1140** 4000K/1202 lm/12.5W **11SD** Sunset/1050 lm/12.5W **11HC** Human Centric/1050 lm/12.5W

1327 2700K/1260 lm/12.5W **1330** 3000K/1312 lm/12.5W **1335** 3500K/1365 lm/12.5W **1340** 4000K/1420 lm/12.5W

1527 2700K/1439 lm/14.7W **1530** 3000K/1501 lm/14.7W **1535** 3500K/1565 lm/14.7W **1540** 4000K/1627 lm/14.7W

Dimmability: For full list of dimmers, refer to the Dimmer Compatibility List. Industry-leading dimming that dims smoothly with no hot spots or flickering.

Listings: cUL Listed for Damp Locations. RoHS Compliant. Meets Energy Star & California Title 24 JA8-2019 standards.

Warranty: ELCO Products are built to last with a 5-year Limited Warranty.

Product Numbers

Item	Lamp type	Lumens	CCT	Watts	Voltage	Dimming	Beam Angle	Finish
E36MW-0727	LED	750 lm	2700K	10.5W	120V	Triac/ELV	38°	All White
E36MB-0727	LED	750 lm	2700K	10.5W	120V	Triac/ELV	38°	All Black
E36MB-11SD	LED	1150 lm	SunsetK	12.5W	120V	Triac/ELV	38°	All Black
E36MW-11SD	LED	1150 lm	SunsetK	12.5W	120V	Triac/ELV	38°	All White
E36MW-11HC	LED	1050 lm	Human CentricK	12.5W	120V	Triac/ELV	38°	All White
E36MS-09SD	LED	950 lm	SunsetK	10.5W	120V	Triac/ELV	38°	All Silver
E36MB-09SD	LED	950 lm	SunsetK	10.5W	120V	Triac/ELV	38°	All Black
E36MW-09SD	LED	950 lm	SunsetK	10.5W	120V	Triac/ELV	38°	All White
E36MS-11SD	LED	1150 lm	SunsetK	12.5W	120V	Triac/ELV	38°	All Silver
E36MS-11HC	LED	1050 lm	Human CentricK	12.5W	120V	Triac/ELV	38°	All Silver
E36MS-1140	LED	1150 lm	4000K	12.5W	120V	Triac/ELV	38°	All Silver
E36MS-1135	LED	1150 lm	3500K	12.5W	120V	Triac/ELV	38°	All Silver
E36MS-1130	LED	1150 lm	3000K	12.5W	120V	Triac/ELV	38°	All Silver
E36MS-1127	LED	1150 lm	2700K	12.5W	120V	Triac/ELV	38°	All Silver
E36MB-11SD	LED	950 lm	SunsetK	12.5W	120V	Triac/ELV	38°	All Black
E36MB-11HC	LED	1050 lm	Human CentricK	12.5W	120V	Triac/ELV	38°	All Black
E36MB-1140	LED	1150 lm	4000K	12.5W	120V	Triac/ELV	38°	All Black
E36MB-1135	LED	1150 lm	3500K	12.5W	120V	Triac/ELV	38°	All Black
E36MB-1130	LED	1150 lm	3000K	12.5W	120V	Triac/ELV	38°	All Black
E36MB-1127	LED	1150 lm	2700K	12.5W	120V	Triac/ELV	38°	All Black
E36MW-1140	LED	1150 lm	4000K	12.5W	120V	Triac/ELV	38°	All White
E36MW-1135	LED	1150 lm	3500K	12.5W	120V	Triac/ELV	38°	All White
E36MW-1130	LED	1150 lm	3000K	12.5W	120V	Triac/ELV	38°	All White
E36MW-1127	LED	1150 lm	2700K	12.5W	120V	Triac/ELV	38°	All White
E36MS-0940	LED	950 lm	4000K	10.5W	120V	Triac/ELV	38°	All Silver
E36MS-0935	LED	950 lm	3500K	10.5W	120V	Triac/ELV	38°	All Silver
E36MS-0930	LED	950 lm	3000K	10.5W	120V	Triac/ELV	38°	All Silver
E36MS-0927	LED	950 lm	2700K	10.5W	120V	Triac/ELV	38°	All Silver
E36MB-0940	LED	950 lm	4000K	10.5W	120V	Triac/ELV	38°	All Black
E36MB-0935	LED	950 lm	3500K	10.5W	120V	Triac/ELV	38°	All Black
E36MB-0930	LED	950 lm	3000K	10.5W	120V	Triac/ELV	38°	All Black
E36MB-0927	LED	950 lm	2700K	10.5W	120V	Triac/ELV	38°	All Black
E36MW-0940	LED	950 lm	4000K	10.5W	120V	Triac/ELV	38°	All White
E36MW-0935	LED	950 lm	3500K	10.5W	120V	Triac/ELV	38°	All White
E36MW-0930	LED	950 lm	3000K	10.5W	120V	Triac/ELV	38°	All White
E36MW-0927	LED	950 lm	2700K	10.5W	120V	Triac/ELV	38°	All White
E36MS-0740	LED	750 lm	4000K	10.5W	120V	Triac/ELV	38°	All Silver
E36MS-0735	LED	750 lm	3500K	10.5W	120V	Triac/ELV	38°	All Silver
E36MS-0730	LED	750 lm	3000K	10.5W	120V	Triac/ELV	38°	All Silver
E36MB-0740	LED	750 lm	4000K	10.5W	120V	Triac/ELV	38°	All Black
E36MB-0735	LED	750 lm	3500K	10.5W	120V	Triac/ELV	38°	All Black
E36MB-0730	LED	750 lm	3000K	10.5W	120V	Triac/ELV	38°	All Black
E36MW-0740	LED	750 lm	4000K	10.5W	120V	Triac/ELV	38°	All White
E36MW-0735	LED	750 lm	3500K	10.5W	120V	Triac/ELV	38°	All White
E36MW-0730	LED	750 lm	3000K	10.5W	120V	Triac/ELV	38°	All White
E36MS-0727	LED	750 lm	2700K	10.5W	120V	Triac/ELV	38°	All Silver
E36MW-08CT5	LED	825 lm	2700K, 3000K, 3500K, 4000K, 5000K	10.5W	120V	Triac/ELV	38°	All White
E36MB-08CT5	LED	825 lm	2700K, 3000K, 3500K, 4000K, 5000K	10.5W	120V	Triac/ELV	38°	All Black

Item	Lamp type	Lumens	CCT	Watts	Voltage	Dimming	Beam Angle	Finish
E36MS-08CT5	LED	825 lm	2700K, 3000K, 3500K, 4000K, 5000K	10.5W	120V	Triac/ELV	38°	All Silver
E36MW-10CT5	LED	1000 lm	2700K, 3000K, 3500K, 4000K, 5000K	12.5W	120V	Triac/ELV	38°	All White
E36MB-10CT5	LED	1000 lm	2700K, 3000K, 3500K, 4000K, 5000K	12.5W	120V	Triac/ELV	38°	All Black
E36MS-10CT5	LED	1000 lm	2700K, 3000K, 3500K, 4000K, 5000K	12.5W	120V	Triac/ELV	38°	All Silver
E36MW-0327	LED	350 lm	2700KK	5W	120V	Triac/ELV	38°	All White
E36MB-0327	LED	350 lm	2700KK	5W	120V	Triac/ELV	38°	All Black
E36MS-0327	LED	350 lm	2700KK	5W	120V	Triac/ELV	38°	All Silver
E36MW-0330	LED	350 lm	3000KK	5W	120V	Triac/ELV	38°	All White
E36MB-0330	LED	350 lm	3000KK	5W	120V	Triac/ELV	38°	All Black
E36MS-0330	LED	350 lm	3000KK	5W	120V	Triac/ELV	38°	All Silver
E36MS-1527	LED	1500 lm	2700K	14.7W	120V	Triac/ELV	38°	All Silver
E36MS-1540	LED	1500 lm	4000K	14.7W	120V	Triac/ELV	38°	All Silver
E36MS-1535	LED	1500 lm	3500K	14.7W	120V	Triac/ELV	38°	All Silver
E36MS-1530	LED	1500 lm	3000K	14.7W	120V	Triac/ELV	38°	All Silver
E36MB-1527	LED	1500 lm	2700K	14.7W	120V	Triac/ELV	38°	All Black
E36MB-1540	LED	1500 lm	4000K	14.7W	120V	Triac/ELV	38°	All Black
E36MB-1535	LED	1500 lm	3500K	14.7W	120V	Triac/ELV	38°	All Black
E36MB-1530	LED	1500 lm	3000K	14.7W	120V	Triac/ELV	38°	All Black
E36MB-15SD	LED	1500 lm	SunsetK	14.7W	120V	Triac/ELV	38°	All Black
E36MW-1527	LED	1500 lm	2700K	14.7W	120V	Triac/ELV	38°	All White
E36MW-1540	LED	1500 lm	4000K	14.7W	120V	Triac/ELV	38°	All White
E36MW-1535	LED	1500 lm	3500K	14.7W	120V	Triac/ELV	38°	All White
E36MW-1530	LED	1500 lm	3000K	14.7W	120V	Triac/ELV	38°	All White
E36MB-1124	LED	1060 lm	2400KK	12.5W	120V	Triac/ELV	38°	All Black
E36MW-1124	LED	1060 lm	2400KK	12.5W	120V	Triac/ELV	38°	All White
E36MS-1124	LED	1060 lm	2400KK	12.5W	120V	Triac/ELV	38°	All Silver
E36MB-0324	LED	350 lm	2400KK	5W	120V	Triac/ELV	38°	All Black
E36MW-0324	LED	350 lm	2400KK	5W	120V	Triac/ELV	38°	All White
E36MS-0324	LED	350 lm	2400KK	5W	120V	Triac/ELV	38°	All Silver
E36MB-0724	LED	750 lm	2400KK	10.5W	120V	Triac/ELV	38°	All Black
E36MW-0724	LED	750 lm	2400KK	10.5W	120V	Triac/ELV	38°	All White
E36MS-0724	LED	750 lm	2400KK	10.5W	120V	Triac/ELV	38°	All Silver
E36MB-0924	LED	950 lm	2400KK	10.5W	120V	Triac/ELV	38°	All Black
E36MW-0924	LED	950 lm	2400KK	10.5W	120V	Triac/ELV	38°	All White
E36MS-0924	LED	950 lm	2400KK	10.5W	120V	Triac/ELV	38°	All Silver
E36MB-1524	LED	1500 lm	2400KK	14.7W	120V	Triac/ELV	38°	All Black
E36MW-1524	LED	1500 lm	2400KK	14.7W	120V	Triac/ELV	38°	All White
E36MS-1524	LED	1500 lm	2400KK	14.7W	120V	Triac/ELV	38°	All Silver
E36MW-0724D	LED	750 lm	2400KK	10.5W	120/277V	0-10V/Triac/ELV (1% Dimming)	38°	All White

Product Number Builder Example: **E36MW-0727**

Koto Sylo™	Style	Finish	Koto™ Module	Color Temp.	Voltage	Beam Angle	Length
E36	M Monopoint	W All White B All Black S All Silver	-03 350 lm (5W) ^{1, 2} -07 750 lm (10.5W) -09 950 lm (10.5W) -11 1150 lm (12.5W) -13 1350 lm (12.5W) -15 1500 lm (14.7W) -18 1800 lm (18.9W) -08 825 lm (10.5W) ^{1, 3} -10 1000 lm (12.5W) ^{1, 3}	24 2400K 27 2700K 30 3000K 35 3500K 40 4000K SD Sunset ^{4, 5} HC Human Centric (-11 only) ^{1, 6, 7} CT5 ⁹ 2700K - 5000K ⁸	120V, Triac/ELV D 120/277V, 0-10V/Triac/ELV	38° lens ¹⁰ -S 18° lens -N 25° lens -W 60° lens -T 10° lens ^{1, 11}	Standard -12 12" Stem ¹² -24 24" Stem ¹² -36 36" Stem ¹² -48 48" Stem ¹² -60 60" Stem ¹²

¹ Available as 120V, Triac/ELV only

² Available with 2400K, 2700K and 3000K Color Temperature Only

³ Available with CT5 color temperature only

⁴ Available with -09, -11, -13 and -15 lumen outputs only

⁵ Sunset, Dim to Warm technology, automatically transitions from 3000K to 1800K when dimmed

⁶ Available with 1150 lumen (-11) outputs only

⁷ Human Centric, Dim to Warm technology, automatically transitions from 4000K to 2200K when dimmed

⁸ Available with -08 and -10 lumen outputs only

⁹ Available as 120V, Triac/ELV only

¹⁰ Includes 25° and 60° lens in the box

¹¹ Available with 350 and 750 lumen, 2700K and 3000K options only

¹² Stem is not field cuttable

Compatible Products



For use with Dedicated **Koto Sylo™** Fixtures

Junction Boxes for Koto Sylo™ Ceiling Mount Fixtures

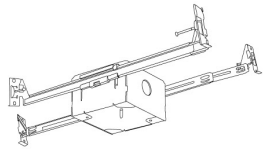

Junction Box with Hanger Bars
New Construction

CAT NO.	SPECIFICATIONS
ELJ4S	3 3/4" x 3 3/4" x 2 3/8"

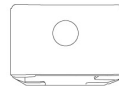

Junction Box without Hanger Bars
New Construction

CAT NO.	SPECIFICATIONS
ELJ332	3 3/4" x 3 3/4" x 2 3/8"

Accessories



Hard Wire Adapter

CAT NO.	SPECIFICATIONS
PSA38	Socket Adapter



4" Hard Wire Adapter

CAT NO.	SPECIFICATIONS
PSA38-4	4"

Other Compatible Junction Boxes



3 1/2" & 4" Octagon
Steel Junction Boxes

- 4" x 4" x 1 1/2"
- 4" x 4" x 2 1/8"
- 3 1/2" x 3 1/2" x 1 1/2"



4" Round Surface
Mount Box

4" O.D. x 1 1/2"



3 1/2" Round Old Work
(Non-Metallic)

4 1/4" O.D. x 3 1/2" I.D. x 2 5/8"

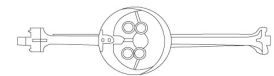

3 1/2" & 4" Round New Work
(Non-Metallic)

4" O.D. x 2 3/16"
3 1/2" O. D x 2 3/4"

Accessories

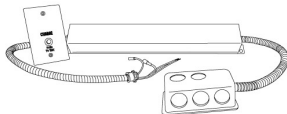

Emergency Battery Backup

CAT NO.	SPECIFICATIONS
KEM-ERT	25W, 120/277V

Koto™ LED Module Accessories



Lens

EP731C	18° Lens
EP732C	25° Lens
EP733C	38° Lens
EP734C	60° Lens

**EP732C, EP733C, EP734C Included*



Reflectors

EP735C	15°
EP736C	25°
EP737C	38°
EP738C	60°



Secondary Optics

L45	Hex Louver
L46	Linear Louver
L47	Spread Louver
L49	Frosted Lens
L51	Color Shifter



Snoot

L50W	White
L50B	Black



ELCO Lighting

Dimmer Compatibility Chart

Standard Koto™ LED Modules

For ELK07, ELK08CT5, ELK09, ELK10CT5,
ELK11 & ELK13 Series

For Reference Only

Testing conducted by ELCO Lighting is not a substitute for and does not imply certification by an independent laboratory or any other standards certification. Refer to manufacturer specifications for more detailed information on product certifications and standards. Consult the dimmer manufacturer prior to installation to ensure compatibility.

Manufacturer	Product	Part Number	Dimmed Light Output Range
Leviton	Decora SureSlide® Single Pole with Slide -to-Off	6672	15% - 100%
	Leviton Dimmer	1K3502	5% - 100%
Lutron	Vive, 120V, 150W LED/CFL, 600W Incandescent/Halogen, FP, Single Pole/Multi-Location Dimmer, Commercial Application	MRF2S-6CL	12% - 91%
	Panel Model, Commercial/Residential Application, FP	GP (Harrier) Card	10% - 94%
	Grafik QS/Mailbox Power Module, 120/220 to 240V AC, LED/Incandescent/Halogen Load Type, Commercial/Residential Indoor Application, FP	LQRJ-WPM-6P	10% - 95%
	Grafik Eye 3000/HomeWorks, 120V, Incandescent/Fluorescent Load Type, Commercial/Residential Application, FP	HWI-WPM-6D-120	10% - 95%
	Panel Dimming Module, 120V, Commercial/Residential Application, FP	HW/LP-RPM-4U-120	10% - 95%
	Panel Adaptive Dimming Module, 120V, Commercial/Residential Application, FP	HW/LP-RPM-4A-120	9% - 95%
	HomeWorks® QS for CFL/LED loads, 120V, RP, Commercial/Residential Application	LQSE-4A1-D/MQSE-4A1-D/ MQSE-3A1/MQSE-2A1-D	8% - 95%
	Energi Savr Node LED+ Phase Adaptive, Commercial Application, Reverse Phase, (Zone 1) (Zones 2-4)	QSN-4A5-S	8% - 95%
	Energi Savr Node LED+ Phase Adaptive, Commercial Application, Forward Phase, (Zone 1) (Zones 2-4)	QSN-4A5-S	10% - 97%
	RadioRA®2, 120V, 50/60-Hz, 150W LED or 600W Incandescent/Halogen, 3-Way & 4-Way, Residential Application	RRD-6CL	10% - 95%
	RadioRA®3, 120V, 250W LED/CFL or 500W Incandescent/Halogen, Single Pole, Multi-Location	RRST-PRO-N	10% - 95%
	HomeWorks® QS, 120V, 60-Hz, 150W LED/CFL or 600W Incandescent/Halogen/MLV, Residential Application	HQRD-6CL(H2) HQRA-6CL(H2)	10% - 95%
	Homeworks QS, Residential Application, Reverse Phase	LQSE-4A-120-D	8% - 89%
	HomeWorks® for LED/Incandescent/Halogen loads, Reverse Phase, (Zone 1) (Zones 2-4)	LQSE-4A5-120-D	8% - 89%
	HomeWorks® for LED/Incandescent/Halogen loads, Forward Phase, (Zone 1) (Zones 2-4)	LQSE-4A5-120-D	10% - 100%
	Ariadni® C-L Single Pole/3-Way, 150W LED/CFL or 600W Incandescent/Halogen	AYCL-153P	10% - 100%
	Skylark Contour® C-L, Single Pole/3-Way, 150W LED/CFL or 600W Incandescent/Halogen	CTCL-153P	10% - 100%
Skylark® C-L Single Pole/3-Way, 150W LED/CFL or 600W Incandescent/Halogen	SCL-153P	10% - 100%	

Integrating our lighting with your Smart Home System is a breeze. Simply check your Smart Home system for compatible smart switches and cross reference that with our Dimming Compatibility Chart. Once the switches are integrated with your Smart Home system your lights will be ready to go.



2042 E. Vernon Ave. Vernon CA 90058 Tel 323.231.2600 Fax 323.231.3200 elcolighting.com

Manufacturer	Product	Part Number	Dimmed Light Output Range
Lutron	Diva® Series 150W Single Pole/3-Way Dimmer	DVCL-153P	10% - 100%
	Skylark Contour® Single Pole/3-Way 1000W Incandescent/Halogen	CT-103P	10% - 100%
	Skylark® Single Pole 300W ELV Preset Dimmer	SELV-300P	5% - 100%
	Skylark® Single Pole 600W Incandescent/Halogen, Slide-to-Off Dimmer	S-600P	5% - 100%
	Diva® 300W Single Pole/3-Way ELV Dimmer	DVELV-303P	10% - 100%
	Diva® 600W Single Pole Incandescent/Halogen Preset Dimmer	DV-600P	5% - 100%
	Ariadni® 600W Single Pole Magnetic Low Voltage Dimmer	AYLV-600P	5% - 100%
	Ariadni® 600W Single Pole/3-Way Incandescent/Halogen Dimmer	AY-603P	5% - 100%
	Maestro® 600W Single Pole/3-Way ELV Dimmer	MAELV-600	5% - 100%
	Maestro® C-L Single Pole/3-Way Dimmer. 150W Max for LED/CFL or 600W Max for Incandescent/Halogen	MACL-153M	10% - 100%
	Caséta® Wireless Dimmer	PD-6WCL	10% - 100%
SnapOne™	Control4® Centralized 8-Channel Adaptive Phase Dimmer, 120/277V AC, 50/60-Hz, 200W LED, 500W Fluorescent/CFL, 1000W Incandescent/Halogen/ELV/MLV*	C4-DIN-8APD	5% - 100%
	Control4® Centralized 8-Channel Forward Phase Dimmer, 100/120V AC, 50/60-Hz, 200W LED, 500W Fluorescent/CFL, 1000W Incandescent/Halogen/MLV*	C4-DIN-8FPD	25% - 100%
	Control4® Wireless Adaptive Phase Dimmer, 120V AC, 50/60-Hz, 120W LED, 300W Fluorescent/CFL, 600W Incandescent/Halogen	C4-APD120	23% - 100%
	Control4® Forward Phase Dimmer, 120V AC, 50/60-Hz, 200W LED, 500W Fluorescent/CFL, 1000W Incandescent/Halogen	C4-FPD120	4% - 100%
	Control4® Essential Forward Phase Dimmer, 120V AC, 60-Hz, 300W LED, 300W Fluorescent/CFL, 600W Incandescent/Halogen	C4-V-FPD120	1% - 100%
*MLV each transformer must be loaded to at least 50% of its maximum load			

***NOTE: Refer to dimmer manufacturer’s documentation for installation instructions and circuit details**

Disclaimer: Minimum and maximum loads for LEDs and CFLs are given in number of lamps and may vary depending on the lamp being used. Testing conducted by ELCO Lighting is not a substitute for and does not imply certification by an independent laboratory or any other standards certification. Refer to manufacturer specifications for more detailed information on product certifications and standards.

Integrating our lighting with your Smart Home System is a breeze. Simply check your Smart Home system for compatible smart switches and cross reference that with our Dimming Compatibility Chart. Once the switches are integrated with your Smart Home system your lights will be ready to go.



2042 E. Vernon Ave. Vernon CA 90058 Tel 323.231.2600 Fax 323.231.3200 elcolighting.com