

3" Koto™ Architectural Shallow Maximum Adjustability IC Airtight Housing



Koto™ Architectural Housing: 120/277V (0-10V/Triac/ELV) or 120V (Triac/ELV) with optional Emergency Battery Backup. Must be used with Koto™ Architectural LED Light Engines (ELK19 or ELK21 Series). Lumen output based on module.

Features

- IC Airtight for direct contact with insulation.
- Easy-to-Remove driver.
- Optional 90 minutes, 120/277 VAC, 60Hz, Emergency Backup.
- Flicker-Free Dimming.
- USA designed and assembled.
- Limited 5 year warranty.
- For use with ELCO Koto™ Architectural LED Light Engines (ELK19 or ELK21 Series).

Specifications

Wattage	14.7W
Lumens	850 (ELK19) - 1100 (ELK21) lm
Voltage	120/277V or 120V
Dimmable	Triac/ELV, 0-10V/Triac/ELV
Lamp Type	LED
Power Factor	≥0.95
Damp Location	Listed

Dimensions

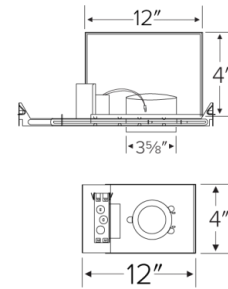

Technical Details

Construction: Single Wall IC Rated for direct contact with insulation. For use in IC and Non-IC conditions. Up to 1100 lumens. Housing adjusts in frame to accommodate up to 1 1/2" ceiling thickness. Airtight housing with gasket to restrict airflow in accordance with ASTM E-283 air-tight requirements.

Installation: Designed for ceiling plenums where 2x6 joists or taller are used. High strength hanger bars can easily be nailed to joists. Suitable for T-grid and drop ceiling applications. See installation sheet for detailed information. Emergency Battery Back-up Option requires access from above. For use with ELCO Koto™ Architectural LED Light Engines (ELK19 or ELK21 Series)

Junction Box: Positioned to accommodate straight conduit runs. Two 3/4" knockouts, Seven 1/2" trade size conduit knockouts, One 3/8" knockout. Four Pry-out knockout slots for easy romex installation.

Hanger Bars: Pre Installed hanger bars with True Nail easy installation in regular lumber, engineered lumber, and Laminated Beams. Integral T-bar slots for easy installation in T-Bars. Spans up 24" and can be repositioned 90°. Score lines allow for tool-free hanger bar size reduction. Integral leveling flange allows for single-person installation while easily aligning the housings with the joists.

Electrical: Driver is rated for 120V and 277V input (120/277V). High Efficiency driver with a power factor > 0.95.

Dimmability: 3-in-1 dimming: Triac, ELV and 0-10V dimming in one driver. 0-10V dimming down to 5% with a compatible dimmer. Can be specified with Lutron drivers for 0.1% and 1% dimming. For a full list of dimmers refer to the Dimmer Compatibility List.

Listings: UL Listed for Damp Location and for Wet Location with select trims. UL Listed for Direct Contact with Insulation and Combustible Material. UL Listed for Feed Through.

Product Numbers

Item	Description	Lamp type	Lumens	Watts	Voltage	Dimming
E3LK76ICA	Shallow Maximum Adjustability Housing	LED	850 (ELK19) - 1100 (ELK21) lm	14.7W	120V	Triac/ELV
E3LK77ICAD	Shallow Maximum Adjustability Housing	LED	850 (ELK19) - 1100 (ELK21) lm	14.7W	120/277V	0-10V/Triac/ELV

Product Number Builder

Example: **E3LK76ICA**

Koto™ Architectural Housing

E3LK

Voltage

76 120V
77 120/277V

Dimming

ICA Triac/ELV
ICAD 0-10V/Triac/ELV

Compatible Products

For use with Dedicated 3" Architectural ICA LED Housings



Koto™ Architectural LED Light Engine

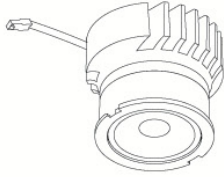

Koto™ LED Light Engine
ELK21

PRODUCT NUMBER BUILDER			
Koto™ LED Light Engine	Lumens	Color Temperature	Beam Angle
ELK	21 1100-1500lm	27D 2700K 30D 3000K 35D 3500K 40D 4000K	(blank) 38° lens (Standard) -S 18° lens -N 25° lens -W 60° lens

ACCESSORIES	
Lens	Reflectors
EP731C 18° Lens	EP735C 15°
EP732C 25° Lens	EP736C 25°
EP733C 38° Lens	EP737C 38°
EP734C 60° Lens	EP738C 60°
<small>*EP732C, EP733C, EP734C Included</small>	
Secondary Optics	
L45 Hex Louver	
L46 Linear Louver	
L47 Spread Louver	

3" Pex™ Twist-&-Lock Trims

Deep Reflector
ELK3618
Finishes:
(W, BB, BZ, B, C, H)

Adjustable Gimbal
ELK3629
Finishes:
(W, BB, BZ, B, C, H)

Adjustable Pinhole
ELK3627
Finishes:
(B, BB, BZ)

Adjustable Baffle
ELK3693
Finishes:
(W)

Slot Aperture
ELK3620
Finishes:
(W)

Adj. Reflector Wall Wash
ELK3622
Finishes:
(W)

Sq. Deep Reflector
ELK3318
Finishes:
(W, BB, BZ, B, C, H)

Sq. Adjustable Gimbal
ELK3329
Finishes:
(W, BB, BZ, B, C, H)

Sq. Adjustable Wall Wash
ELK3322
Finishes:
(W)

Sq. Adjustable Baffle
ELK3393
Finishes:
(W)

Sq. Adjustable Pinhole
ELK3327
Finishes:
(B, BB, BZ)

*Finishes: **W** - All White, **BB** - All Black, **BZ** - All Bronze, **B** - Black Reflector w/White Ring, **C** - Chrome Reflector w/White Ring, **H** - Haze Reflector w/White Ring

