

# 2" Sylo™ Surface Mount with Koto™ Focus Module

Adjustable Focus: 18° to 50° with a simple twist of the snoot



## Features

- Modern Die-Cast aluminum fixture for easy maintenance and upgrades
- Fits 3 ½" and 4" Octagon and Round Junction boxes
- Sunset option dims from 3000K to 1800K
- Energy Star Certified. Title 24 JA8-2019 Compliant
- Life span of 50,000 hours L70
- Integrated 120V Dimmable Driver Triac/ELV
- Excellent color rendering 95+ CRI
- Adjustable Focus: 18° to 50° with a simple twist of the lens
- Covered by U.S. PATENTS and Patents Pending

## Specifications

|                      |                           |
|----------------------|---------------------------|
| <b>Wattage</b>       | 10.5W                     |
| <b>Lumens</b>        | 860 lm                    |
| <b>Voltage</b>       | 120V                      |
| <b>Color Temp.</b>   | 4000K                     |
| <b>Dimmable</b>      | Triac/ELV                 |
| <b>Lamp Type</b>     | LED                       |
| <b>Beam Angle</b>    | Adjustable Beam 18° - 50° |
| <b>CRI</b>           | 95+                       |
| <b>Damp Location</b> | cUL Listed                |

## Options



White



Black



Silver

## Technical Details

**Optics:** Polycarbonate module lens diffuses light evenly throughout while reducing glare with LED technology.

**Construction:** Integrated driver and light engine with quick connect. Diecast aluminum body with heat fins allows for efficient cooling.

**Installation:** Twist-lock design for toolless trim installation, for use with Koto Sylo™ products only.

**Electrical:** Module connects to 120 power supply. High-efficiency driver with a power factor >0.9. Start time of less than 0.75 seconds.

**LED Technology:** Extremely accurate Color Rendering Index of 95+. Lumen Maintenance of 50,000 hours L70 Life based on LM80 standardized test results. Superior Thermal Management by utilizing integrated heat sink. Instant On to Full Brightness technology. No LED pixelation.

**Sunset:** Sunset color temperature is our dim-to-warm LED technology that allows the color temperature to become warmer as the product is dimmed. Our SUNSET items start at 3000K and go as low as 1800K when dimmed. For Sunset dim technology be sure to order an item with "Sunset" in the Color Temperature (CCT) attribute.

**Dimmability:** Works with 120V Triac and ELV type dimmers. Dims down to 10%. For full list of dimmers, refer to the Dimmer Compatibility List. Industry-leading dimming that dims smoothly with no hot spots or flickering.

**Listings:** cUL Listed for Damp Locations. RoHS Compliant. Meets Energy Star & California Title 24 JA8-2019 standards.

**Warranty:** ELCO Products are built to last with a 5-year Limited Warranty.

## Dimensions

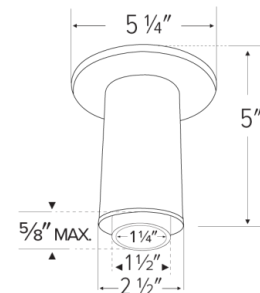

**Product Number Builder** Example: **E25FW-0727-FC**

| Koto Sylo™ | Style                  | Finish                                                      | Koto™ Focus Module                    | Color Temperature                                                                                         | Beam Angle           |
|------------|------------------------|-------------------------------------------------------------|---------------------------------------|-----------------------------------------------------------------------------------------------------------|----------------------|
| <b>E25</b> |                        |                                                             |                                       |                                                                                                           |                      |
|            | <b>F</b> Surface Mount | <b>W</b> All White<br><b>B</b> All Black<br><b>S</b> Silver | <b>-07</b> 770 lm - 860 lm<br>(10.5W) | <b>27</b> 2700K<br><b>30</b> 3000K<br><b>35</b> 3500K<br><b>40</b> 4000K<br><b>SD</b> Sunset <sup>1</sup> | <b>-FC</b> 18° - 50° |

<sup>1</sup> Sunset, Dim to Warm technology, automatically transitions from 3000K to 1800K when dimmed

# Compatible Products

For use with Dedicated 2" Koto Sylo™ Fixtures

## Junction Boxes for Koto Sylo™ Ceiling Mount Fixtures

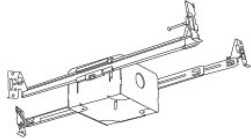

Junction Box  
with Hanger Bars  
**New Construction**

| CAT NO. | SPECIFICATIONS           |
|---------|--------------------------|
| ELJ4S   | 3 3/4" x 3 3/4" x 2 3/8" |

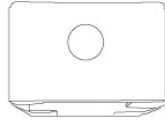

Junction Box  
without Hanger Bars  
**New Construction**

| CAT NO. | SPECIFICATIONS           |
|---------|--------------------------|
| ELJ332  | 3 3/4" x 3 3/4" x 2 3/8" |

### Accessories

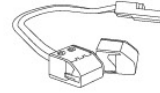

**Hard Wire Adapter**

| CAT NO. | SPECIFICATIONS |
|---------|----------------|
| PSA38   | Socket Adapter |



**4" Hard Wire Adapter**

| CAT NO. | SPECIFICATIONS |
|---------|----------------|
| PSA38-4 | 4"             |

### Other Compatible Junction Boxes



3 1/2" & 4" Octagon  
**Steel Junction Boxes**

- 4" x 4" x 1 1/2"
- 4" x 4" x 2 1/8"
- 3 1/2" x 3 1/2" x 1 1/2"



4" Round Surface  
**Mount Box**

- 4" O.D. x 1 1/2"



3 1/2" Round Old  
Work  
**(Non-Metallic)**

- 4 1/4" O.D. x 3 1/2" I.D. x 2 5/8"

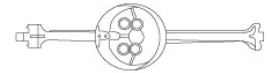

3 1/2" & 4" Round  
New Work  
**(Non-Metallic)**

- 4" O.D. x 2 3/16"
- 3 1/2" O. D x 2 3/4"

## 2" Accessories

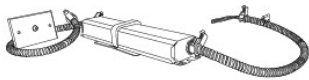

**Emergency Battery Backup**

| CAT NO. | SPECIFICATIONS |
|---------|----------------|
| KEM-LD5 | 8W, 120/277V   |



**ELCO Lighting**

# Dimmer Compatibility Chart

## Standard Koto™ LED Modules

For ELK07, ELK08CT5, ELK09, ELK10CT5, ELK11 & ELK13 Series

### For Reference Only

Testing conducted by ELCO Lighting is not a substitute for and does not imply certification by an independent laboratory or any other standards certification. Refer to manufacturer specifications for more detailed information on product certifications and standards. Consult the dimmer manufacturer prior to installation to ensure compatibility.

| Manufacturer                                                              | Product                                                                                                                               | Part Number                                   | Dimmed Light Output Range |
|---------------------------------------------------------------------------|---------------------------------------------------------------------------------------------------------------------------------------|-----------------------------------------------|---------------------------|
| Leviton                                                                   | Decora SureSlide® Single Pole with Slide -to-Off                                                                                      | 6672                                          | 15% - 100%                |
|                                                                           | Leviton Dimmer                                                                                                                        | 1K3502                                        | 5% - 100%                 |
| Lutron                                                                    | Vive, 120V, 150W LED/CFL, 600W Incandescent/Halogen, FP, Single Pole/Multi-Location Dimmer, Commercial Application                    | MRF2S-6CL                                     | 12% - 91%                 |
|                                                                           | Panel Model, Commercial/Residential Application, FP                                                                                   | GP (Harrier) Card                             | 10% - 94%                 |
|                                                                           | Grafik QS/Mailbox Power Module, 120/220 to 240V AC, LED/Incandescent/Halogen Load Type, Commercial/Residential Indoor Application, FP | LQRJ-WPM-6P                                   | 10% - 95%                 |
|                                                                           | Grafik Eye 3000/HomeWorks, 120V, Incandescent/Fluorescent Load Type, Commercial/Residential Application, FP                           | HWI-WPM-6D-120                                | 10% - 95%                 |
|                                                                           | Panel Dimming Module, 120V, Commercial/Residential Application, FP                                                                    | HW/LP-RPM-4U-120                              | 10% - 95%                 |
|                                                                           | Panel Adaptive Dimming Module, 120V, Commercial/Residential Application, FP                                                           | HW/LP-RPM-4A-120                              | 9% - 95%                  |
|                                                                           | HomeWorks® QS for CFL/LED loads, 120V, RP, Commercial/Residential Application                                                         | LQSE-4A1-D/MQSE-4A1-D/<br>MQSE-3A1/MQSE-2A1-D | 8% - 95%                  |
|                                                                           | Energi Savr Node LED+ Phase Adaptive, Commercial Application, Reverse Phase, (Zone 1) (Zones 2-4)                                     | QSN-4A5-S                                     | 8% - 95%                  |
|                                                                           | Energi Savr Node LED+ Phase Adaptive, Commercial Application, Forward Phase, (Zone 1) (Zones 2-4)                                     | QSN-4A5-S                                     | 10% - 97%                 |
|                                                                           | RadioRA®2, 120V, 50/60-Hz, 150W LED or 600W Incandescent/Halogen, 3-Way & 4-Way, Residential Application                              | RRD-6CL                                       | 10% - 95%                 |
|                                                                           | RadioRA®3, 120V, 250W LED/CFL or 500W Incandescent/Halogen, Single Pole, Multi-Location                                               | RRST-PRO-N                                    | 10% - 95%                 |
|                                                                           | HomeWorks® QS, 120V, 60-Hz, 150W LED/CFL or 600W Incandescent/Halogen/MLV, Residential Application                                    | HQRD-6CL(H2)<br>HQRA-6CL(H2)                  | 10% - 95%                 |
|                                                                           | Homeworks QS, Residential Application, Reverse Phase                                                                                  | LQSE-4A-120-D                                 | 8% - 89%                  |
|                                                                           | HomeWorks® for LED/Incandescent/Halogen loads, Reverse Phase, (Zone 1) (Zones 2-4)                                                    | LQSE-4A5-120-D                                | 8% - 89%                  |
|                                                                           | HomeWorks® for LED/Incandescent/Halogen loads, Forward Phase, (Zone 1) (Zones 2-4)                                                    | LQSE-4A5-120-D                                | 10% - 100%                |
|                                                                           | Ariadni® C-L Single Pole/3-Way, 150W LED/CFL or 600W Incandescent/Halogen                                                             | AYCL-153P                                     | 10% - 100%                |
|                                                                           | Skylark Contour® C-L, Single Pole/3-Way, 150W LED/CFL or 600W Incandescent/Halogen                                                    | CTCL-153P                                     | 10% - 100%                |
| Skylark® C-L Single Pole/3-Way, 150W LED/CFL or 600W Incandescent/Halogen | SCL-153P                                                                                                                              | 10% - 100%                                    |                           |

Integrating our lighting with your Smart Home System is a breeze. Simply check your Smart Home system for compatible smart switches and cross reference that with our Dimming Compatibility Chart. Once the switches are integrated with your Smart Home system your lights will be ready to go.



2042 E. Vernon Ave. Vernon CA 90058 Tel 323.231.2600 Fax 323.231.3200 [elcolighting.com](http://elcolighting.com)

| Manufacturer                                                             | Product                                                                                                                                           | Part Number | Dimmed Light Output Range |
|--------------------------------------------------------------------------|---------------------------------------------------------------------------------------------------------------------------------------------------|-------------|---------------------------|
| Lutron                                                                   | Diva® Series 150W Single Pole/3-Way Dimmer                                                                                                        | DVCL-153P   | 10% - 100%                |
|                                                                          | Skylark Contour® Single Pole/3-Way 1000W Incandescent/Halogen                                                                                     | CT-103P     | 10% - 100%                |
|                                                                          | Skylark® Single Pole 300W ELV Preset Dimmer                                                                                                       | SELV-300P   | 5% - 100%                 |
|                                                                          | Skylark® Single Pole 600W Incandescent/Halogen, Slide-to-Off Dimmer                                                                               | S-600P      | 5% - 100%                 |
|                                                                          | Diva® 300W Single Pole/3-Way ELV Dimmer                                                                                                           | DVELV-303P  | 10% - 100%                |
|                                                                          | Diva® 600W Single Pole Incandescent/Halogen Preset Dimmer                                                                                         | DV-600P     | 5% - 100%                 |
|                                                                          | Ariadni® 600W Single Pole Magnetic Low Voltage Dimmer                                                                                             | AYLV-600P   | 5% - 100%                 |
|                                                                          | Ariadni® 600W Single Pole/3-Way Incandescent/Halogen Dimmer                                                                                       | AY-603P     | 5% - 100%                 |
|                                                                          | Maestro® 600W Single Pole/3-Way ELV Dimmer                                                                                                        | MAELV-600   | 5% - 100%                 |
|                                                                          | Maestro® C-L Single Pole/3-Way Dimmer. 150W Max for LED/CFL or 600W Max for Incandescent/Halogen                                                  | MACL-153M   | 10% - 100%                |
|                                                                          | Caséta® Wireless Dimmer                                                                                                                           | PD-6WCL     | 10% - 100%                |
| SnapOne™                                                                 | Control4® Centralized 8-Channel Adaptive Phase Dimmer, 120/277V AC, 50/60-Hz, 200W LED, 500W Fluorescent/CFL, 1000W Incandescent/Halogen/ELV/MLV* | C4-DIN-8APD | 5% - 100%                 |
|                                                                          | Control4® Centralized 8-Channel Forward Phase Dimmer, 100/120V AC, 50/60-Hz, 200W LED, 500W Fluorescent/CFL, 1000W Incandescent/Halogen/MLV*      | C4-DIN-8FPD | 25% - 100%                |
|                                                                          | Control4® Wireless Adaptive Phase Dimmer, 120V AC, 50/60-Hz, 120W LED, 300W Fluorescent/CFL, 600W Incandescent/Halogen                            | C4-APD120   | 23% - 100%                |
|                                                                          | Control4® Forward Phase Dimmer, 120V AC, 50/60-Hz, 200W LED, 500W Fluorescent/CFL, 1000W Incandescent/Halogen                                     | C4-FPD120   | 4% - 100%                 |
|                                                                          | Control4® Essential Forward Phase Dimmer, 120V AC, 60-Hz, 300W LED, 300W Fluorescent/CFL, 600W Incandescent/Halogen                               | C4-V-FPD120 | 1% - 100%                 |
| *MLV each transformer must be loaded to at least 50% of its maximum load |                                                                                                                                                   |             |                           |

**\*NOTE: Refer to dimmer manufacturer’s documentation for installation instructions and circuit details**

Disclaimer: Minimum and maximum loads for LEDs and CFLs are given in number of lamps and may vary depending on the lamp being used. Testing conducted by ELCO Lighting is not a substitute for and does not imply certification by an independent laboratory or any other standards certification. Refer to manufacturer specifications for more detailed information on product certifications and standards.

Integrating our lighting with your Smart Home System is a breeze. Simply check your Smart Home system for compatible smart switches and cross reference that with our Dimming Compatibility Chart. Once the switches are integrated with your Smart Home system your lights will be ready to go.



2042 E. Vernon Ave. Vernon CA 90058 Tel 323.231.2600 Fax 323.231.3200 elcolighting.com