

2" Low Voltage Koto Sylo™ Surface Mount

Works with 12V AC and 24V DC Koto™ LED Module



Features

- Modern Die-Cast aluminum fixture for easy maintenance and upgrades
- Includes Standard 38° lens, with 25° and 60° lenses. Optional: 18° lenses available (EP731C)
- Low Voltage fixtures (24V DC and 12V AC options)
- Fits 3 ½" and 4" Octagon and Round Junction boxes
- Sunset option dims from 3000K to 1800K
- Energy Star Compliant. Title 24 JA8-2022 Compliant
- Life span of 50,000 hours L70
- **Sunset** with 12V AC LED Module only (12A)

Specifications

| | |
|--------------------|---------------|
| Wattage | 9W |
| Lumens | 800 lm |
| Voltage | 12V AC |
| Color Temp. | 3000K |
| Lamp Type | LED |
| Beam Angle | 25°, 38°, 60° |
| CRI | 90 |

Options



White



Black



Silver

Technical Details

Optics: Polycarbonate module lens diffuses light evenly throughout while reducing glare with LED technology.

Construction: Integrated driver and light engine. Diecast aluminum body with heat fins allows for efficient cooling.

Installation: Twist-lock design for toolless trim installation, for use with Koto Sylo™ products only.

Electrical: High-efficiency driver with a power factor >0.9. Start time of less than 0.75 seconds.

LED Technology: Extremely accurate Color Rendering Index of 90+. Lumen Maintenance of 50,000 hours L70 Life based on LM80 standardized test results. Superior Thermal Management by utilizing integrated heat sink. Instant On to Full Brightness technology. No LED pixelation.

Sunset: Sunset color temperature is our dim-to-warm LED technology that allows the color temperature to become warmer as the product is dimmed. Our SUNSET items start at 3000K and go as low as 1800K when dimmed. For Sunset dim technology be sure to order an item with "Sunset" in the Color Temperature (CCT) attribute.

Dimmability: Dims down to 10%. For full list of dimmers, refer to the Dimmer Compatibility List. Industry leading dimming.

Warranty: ELCO Products are built to last with a 5-year Limited Warranty.

Dimensions

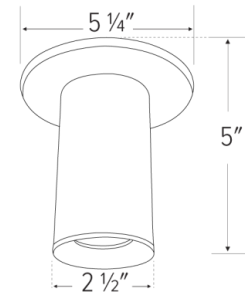

Product Number Builder Example: E25FW-0812A27

| Koto Sylo™ | Style | Finish | Koto™ Module | Voltage | Color Temperature | Beam Angle |
|------------|------------------------|---|---|--|---|--|
| E25 | F Surface Mount | W All White B All Black S Silver | -08 800 lm (9W-10W) ₁ | 12A 12V AC 24D 24V DC | 27 2700K 30 3000K SD Sunset (12A only) ₂ | 38° lens ³ -S 18° lens -N 25° lens -W 60° lens |

¹ (9W) for 12A, (10W) for 24D

² Sunset, Dim to Warm technology, automatically transitions from 3000K to 1800K when dimmed

³ Includes 25° and 60° lens in the box

Compatible Products



For use with **Low Voltage Koto Sylo™** Fixtures

Junction Boxes for Low Voltage Koto Sylo™ Fixtures

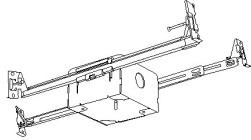

Junction Box with Hanger Bars
New Construction

| CAT NO. | SPECIFICATIONS |
|---------|--------------------------|
| ELJ4S | 3 3/4" x 3 3/4" x 2 3/8" |

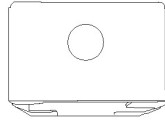

Junction Box without Hanger Bars
New Construction

| CAT NO. | SPECIFICATIONS |
|---------|--------------------------|
| ELJ332 | 3 3/4" x 3 3/4" x 2 3/8" |

Accessories

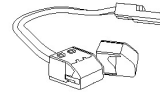

Hard Wire Adapter

| CAT NO. | SPECIFICATIONS |
|---------|----------------|
| PSA38 | Socket Adapter |



4" Hard Wire Adapter

| CAT NO. | SPECIFICATIONS |
|---------|----------------|
| PSA38-4 | 4" |

Other Compatible Junction Boxes

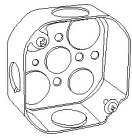

3 1/2" & 4" Octagon
Steel Junction Boxes

4" x 4" x 1 1/2"
4" x 4" x 2 1/8"
3 1/2" x 3 1/2" x 1 1/2"



4" Round Surface
Mount Box

4" O.D. x 1 1/2"

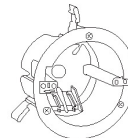

3 1/2" Round Old Work
(Non-Metallic)

4 1/4" O.D. x 3 1/2" I.D. x 2 5/8"

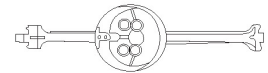

3 1/2" & 4" Round New Work
(Non-Metallic)

4" O.D. x 2 3/16"
3 1/2" O. D x 2 3/4"

Accessories

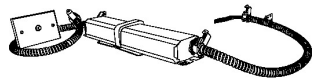

Emergency Battery Backup

| CAT NO. | SPECIFICATIONS |
|---------|----------------|
| KEM-LD5 | 25W, 120/277V |

Koto™ LED Module Accessories



Lens

| | |
|---------------|----------|
| EP731C | 18° Lens |
| EP732C | 25° Lens |
| EP733C | 38° Lens |
| EP734C | 60° Lens |

**EP732C, EP733C, EP734C Included*



Reflectors

| | |
|---------------|-----|
| EP735C | 15° |
| EP736C | 25° |
| EP737C | 38° |
| EP738C | 60° |



Secondary Optics

| | |
|------------|---------------------------------|
| L45 | Hex Louver |
| L46 | Linear Louver |
| L47 | Spread Louver |
| L49 | Frosted Lens |
| L51 | Color Shifter |
| L54 | Single Asymmetric Herculux Lens |
| L55 | Double Asymmetric Herculux Lens |



Snoot

| | |
|-------------|-------|
| L50W | White |
| L50B | Black |

12VAC Transformers

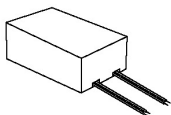

Electronic (No Minimum Load)
Dimmable Driver

| CAT NO. | SPECIFICATIONS |
|------------|------------------------------|
| LET-60 | 60W, 120V Input |
| LET-60-277 | 60W, 277V Input |
| LET-60-H | 60W, 120V Input, Bottom Lead |



0-10V Electronic
Dimmable Driver

| CAT NO. | SPECIFICATIONS |
|--------------|------------------|
| LET-60DX | 60W, 120V, 0-10V |
| LET-60DX-277 | 60W, 277V, 0-10V |

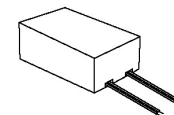

Miniature Electronic
Dimmable Driver

| CAT NO. | SPECIFICATIONS |
|---------|----------------|
| LET-75 | 75W, 12V AC |

Compatible Products



For use with **Low Voltage Koto Sylo™** Fixtures

24V DC Transformers



**Electronic Low Voltage
Dimmable Driver**

| CAT NO. | SPECIFICATIONS |
|------------|-------------------------|
| DRVE24V60W | 60W, 120V Input, 24V DC |



**Constant Voltage
LED Driver**

| CAT NO. | SPECIFICATIONS |
|---------|------------------------------|
| DRV100W | 100W, 120/277V Input, 24V DC |



**0-10V
Dimmable Driver**

| CAT NO. | SPECIFICATIONS |
|-----------|---------------------|
| DRV30W-10 | 30W, 120/277V Input |
| DRV60W-10 | 60W, 120/277V Input |
| DRV96W-10 | 96W, 120/277V Input |



**Universal (Small)
Dimming LED Driver**

| CAT NO. | SPECIFICATIONS |
|-------------|-----------------------------------|
| DRVU24V24WD | 24W, 24V DC (1A), Triac/ELV/MLV |
| DRVU24V60WD | 60W, 24V DC (2.5A), Triac/ELV/MLV |



**Universal (Medium)
Dimming LED Driver**

| CAT NO. | SPECIFICATIONS |
|--------------|----------------------------------|
| DRVU24V100WD | 100W, 24V DC (4A), Triac/ELV/MLV |



**Universal (Large)
Dimming LED Driver**

| CAT NO. | SPECIFICATIONS |
|--------------|----------------------------------|
| DRVU24V200WD | 200W, 24V DC (8A), Triac/ELV/MLV |



**Universal (X-Large)
Dimming LED Driver**

| CAT NO. | SPECIFICATIONS |
|--------------|-----------------------------------|
| DRVU24V300WD | 300W, 24V DC (12A), Triac/ELV/MLV |



**Electronic (Small)
Dimming LED Driver**

| CAT NO. | SPECIFICATIONS |
|-------------|----------------------|
| DRVE24V24DW | 24W, 24V (1A), Triac |

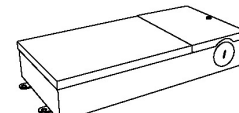

**Magnetic (Large)
Dimming LED Driver**

| CAT NO. | SPECIFICATIONS |
|-------------|------------------------|
| DRVE24V48DW | 48W, 24V (2A), Triac |
| DRVE24V60DW | 60W, 24V (2.5A), Triac |
| DRVE24V96DW | 96W, 24V (4A), Triac |

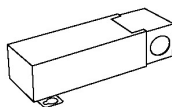

**Magnetic (Small)
Dimming LED Driver**

| CAT NO. | SPECIFICATIONS |
|------------|----------------|
| DRVM24V20W | 20W, 24V DC |
| DRVM24V40W | 40W, 24V DC |



**Magnetic (Medium/Large)
Dimming LED Driver**

| CAT NO. | SPECIFICATIONS |
|-------------|----------------|
| DRVM24V60W | 60W, 24V DC |
| DRVM24V100W | 100W, 24V DC |
| DRVM24V150W | 150W, 24V DC |
| DRVM24V200W | 200W, 24V DC |
| DRVM24V300W | 300W, 24V DC |

Photometric Report

12V AC Retrofit Koto™ LED Module

PHOTOMETRIC REPORT

Product #: ELK0830-12
 Wattage / Lumens: 10W / 971.7 lm
 Luminaire LPW: 97 lm/W

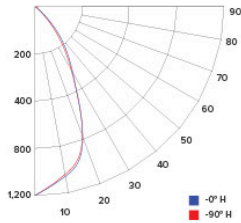

CANDLE POWER SUMMARY

| Degree Vertical | 0° |
|-----------------|------|
| 0 | 1199 |
| 5 | 1152 |
| 15 | 968 |
| 25 | 540 |
| 35 | 252 |
| 45 | 95 |
| 55 | 31 |
| 65 | 13 |
| 75 | 6 |
| 85 | 2 |
| 90 | 1 |

ILLUMINANCE AT A DISTANCE

| Distance to Target Plane | Center Beam Footcandles | Beam Diameter |
|--------------------------|-------------------------|---------------|
| 4' | 103.3 | 3.1' |
| 6' | 36.4 | 4.7' |
| 8' | 18.7 | 6.3' |
| 10' | 12.6 | 7.8' |

ZONAL LUMEN SUMMARY

| Zone | Lumens | %Luminaire |
|-------|--------|------------|
| 0-30° | 565.3 | 70.6 |
| 0-40° | 697.3 | 87.1 |
| 0-60° | 780.3 | 97.5 |
| 0-90° | 796.0 | 99.4 |

Photometric Report

24V DC Koto™ LED Module

PHOTOMETRIC REPORT

Product #: ELK0827-24 (36°)
 Wattage / Lumens: 10W / 860.2 lm
 Luminaire LPW: 86 lm/W

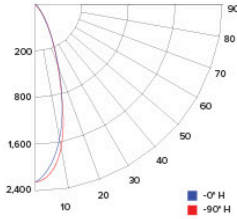

CANDLE POWER SUMMARY

| Degree Vertical | 0° |
|-----------------|------|
| 0 | 2329 |
| 5 | 2082 |
| 15 | 1212 |
| 25 | 301 |
| 35 | 61 |
| 45 | 35 |
| 55 | 22 |
| 65 | 12 |
| 75 | 5 |
| 85 | 0 |
| 90 | 0 |

ILLUMINANCE AT A DISTANCE

| Distance to Target Plane | Center Beam Footcandles | Beam Diameter |
|--------------------------|-------------------------|---------------|
| 4' | 146 | 2.4' |
| 6' | 64.7 | 3.5' |
| 8' | 36.4 | 4.7' |
| 10' | 23.3 | 5.9' |

ZONAL LUMEN SUMMARY

| Zone | Lumens | %Luminaire |
|-------|--------|------------|
| 0-30° | 754.8 | 87.3 |
| 0-40° | 806.2 | 93.2 |
| 0-60° | 850.3 | 98.3 |
| 0-90° | 864.6 | 100 |

PHOTOMETRIC REPORT

Product #: ELK0830-24 (36°)
 Wattage / Lumens: 10W / 901.2 lm
 Luminaire LPW: 90.1 lm/W

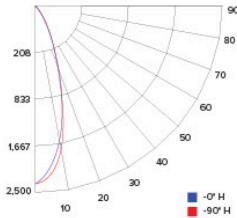

CANDLE POWER SUMMARY

| Degree Vertical | 0° |
|-----------------|------|
| 0 | 2426 |
| 5 | 2169 |
| 15 | 1262 |
| 25 | 314 |
| 35 | 64 |
| 45 | 37 |
| 55 | 23 |
| 65 | 12 |
| 75 | 6 |
| 85 | 0 |
| 90 | 0 |

ILLUMINANCE AT A DISTANCE

| Distance to Target Plane | Center Beam Footcandles | Beam Diameter |
|--------------------------|-------------------------|---------------|
| 4' | 152 | 2.4' |
| 6' | 67.4 | 3.5' |
| 8' | 37.9 | 4.7' |
| 10' | 24.3 | 5.9' |

ZONAL LUMEN SUMMARY

| Zone | Lumens | %Luminaire |
|-------|--------|------------|
| 0-30° | 786.2 | 87.3 |
| 0-40° | 839.8 | 93.2 |
| 0-60° | 885.7 | 98.3 |
| 0-90° | 900.6 | 100 |