

2" IC New Construction Frame



Driver included on frame

Features

- Listed for direct contact with insulation
- Frame specified for 850 lumens (11.8W) and 1100 lumens (13.7W)
- Same LED module for both lumen outputs
- Driver specified for 120V (Triac/ELV dimming) or 120/277V (0-10V/Triac/ELV Dimming)
- Damp Location Listed, Wet Location with Wet Location Light Engines
- JA8-2016-E Listed, ENERGY Star Listed, UL Listed

Specifications

Wattage	11.8W - 13.7W
Lumens	850 lm - 1100 lm
Voltage	120/277V or 120V
Dimmable	Triac/ELV, 0-10V/Triac/ELV

Dimensions

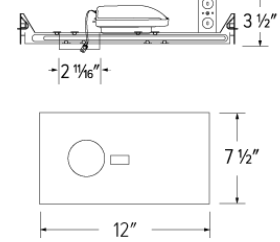

Product Numbers

Item	Lumens	Watts	Voltage	Dimming
E2L08ICA	850 lm	11.8W	120V	Triac/ELV
E2L11ICA	1100 lm	13.7W	120V	Triac/ELV
E2L08ICAD	850 lm	11.8W	120/277V	0-10V/Triac/ELV
E2L11ICAD	1100 lm	13.7W	120/277V	0-10V/Triac/ELV

Product Number Builder Example: E2L08ICA

2" IC New Construction Frame	Lumens	Dimming
E2L	<input type="text"/>	<input type="text"/>
	08 850 lm 11 1100 lm	ICA Triac/ELV ICAD 0-10V/Triac/ELV