

0-10V ALO™ Box on New Construction Frame

Maximum 2-Hour Fire Rated ceiling assembly can be maintained when installed according to the International Building Code, Section 714.



For 4" 0-10V LED Inserts (EL495 Series)

Features

- Junction Box with hanger bars wired for 0-10V dimming
- **Compatible only with 4" 0-10V LED Inserts (EL495 Series)**
- IC Airtight for direct contact with insulation
- For use in IC and Non-IC applications
- Swivel hanger bars for horizontal positioning even after nailing
- Low profile makes ideal in shallow plenum applications
- UL listed under UL 514A Standards as a metallic outlet box
- UL listed under 1598 Standards as a luminaire housing
- Maximum 2-Hour Fire Rated ceiling assembly can be maintained when installed according to the International Building Code, Section 714
- U.S. Patents 10295163 & 10876721, D892069 & D902160, and other U.S. Patents Pending

Technical Details

Construction:

- IC Rated for direct contact with insulation, for use in IC or Non-IC conditions.
- Airtight housing with gasket to restrict airflow in accordance with ASTM E-283 air-tight requirements.

Installation: Designed for ceiling plenums where 2x4 joists or taller joists are used. High strength hanger bars can easily be nailed to joists. Maximum hole cutout is 4 1/4". Suitable for T-grid and drop ceiling applications. See installation sheet for detailed information.

Junction Box: Equipped with (8) trade size knockouts (four on top and four on side walls)

Hanger Bars: Pre-installed hanger bars with true nail facilitate easy installation in regular lumber, engineered lumber, and laminated beams. Integral T-bar slots for easy installation in T-bars. Spans up to 24" and can be repositioned 90°. Score lines allow for tool-free hanger bar size reduction. Integral leveling flange allows for single-person installation while aligning the housings with the joists.

Mounting: Pre-installed mounting brackets allow vertical adjustment of bar hangers for ceilings up to 1.5" thickness.

Dimmability: Dimmability based on lamp.

Lamp: Designed for use with ELCO 4" 0-10V LED inserts (EL495 Series Only)

Listings:

- UL Listed under UL 514A Standards as a metallic outlet box
- UL Listed under 1598 Standards as a luminaire housing
- ASTM E283 certified Air Tight.

Warranty: ELCO Lighting warrants products will be free from defects in materials and workmanship for a period of 5 years.

Options



ELJ444ICDXA-EM5

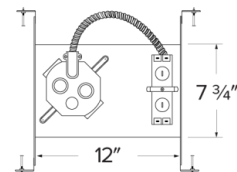
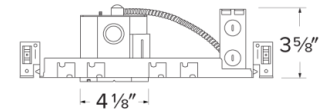

Product Numbers

Item	Description
ELJ444ICDXA	0-10V ALO™ Box on New Construction Frame
ELJ444ICDXA-EM5	0-10V ALO™ Box on New Construction Frame with Emergency Battery Backup

Compatible Products

For use with Dedicated 4" IC LED Housings



4" Ply™ 0-10V Dimmable, 120/277V LED Inserts



Round Insert

EL495

Finishes:

(DW, DHW, DCW)

PRODUCT NUMBER BUILDER

4" 120/277V LED Inserts	Color Temperature	Finish
<input type="text" value="EL495"/>	<input type="text"/>	<input type="text"/>
	30 3000K (800 lm)	DW All White
	35 3500K (850 lm)	DHW Haze w/White Ring
	40 4000K (900 lm)	DCW Chrome w/White Ring