

4" Trimless Cedar System New Construction IC Airtight Housing w/Driver

IC Airtight housing for trimless, high-end residential and light commercial, 850-1600 lumens.



Features

- UL Listed for direct contact with insulation.
- Compatible with 2 x 8 construction.
- Optional 90 minutes, 120/277 VAC, 60Hz, Emergency Backup.
- ENERGY STAR® Certified.
- Flicker-Free Dimming.
- USA designed and assembled.
- Limited 5 year warranty.
- For use with ELCO Cedar™ System 4" Trimless LED Light Engines.

Specifications

Lumens	1600 lm
Voltage	120/277V
Dimmable	Triac/ELV/0-10V
Power Factor	≥0.95
Damp Location	Listed

Dimensions

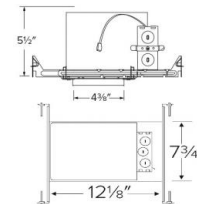

Technical Details

Construction:

- For use in IC and non-IC conditions. Up to 1600 lumens.
- Housing adjusts in frame to accommodate up to 1 1/2" ceiling thickness.
- Airtight housing with gasket to restrict airflow in accordance with ASTM E-283 air-tight requirements.

Installation:

- Designed for ceiling plenums where 2x6 joists or taller are used.
- High strength hanger bars can easily be nailed to joists.
- Suitable for T-grid and drop ceiling applications.
- See installation sheet for detailed information.

Junction Box: Positioned to accommodate straight conduit runs. Two 3/4" knockouts, Seven 1/2" trade size conduit knockouts, One 3/8" knockout. Four Pry-out knockout slots for easy romex installation.

Hanger Bars: Pre Installed hanger bars with True Nail easy installation in regular lumber, engineered lumber, and Laminated Beams. Integral T-bar slots for easy installation in T-Bars. Spans up 24" and can be repositioned 90°. Score lines allow for tool-free hanger bar size reduction. Integral leveling flange allows for single-person installation while easily aligning the housings with the joists.

Electrical:

- Driver is rated for 120V and 277V input (120/277V).
- High Efficiency driver with a power factor > 0.95.

Dimmability:

- 3 in 1 dimming: Triac, ELV and 0-10V dimming in one driver.
- 0-10V dimming down to 5% with a compatible dimmer.
- Can be specified with Lutron drivers for 0.1% and 1% dimming.
- For a full list of dimmers refer to the Dimmer Compatibility List.

Listings: UL Listed for Damp Location and for Wet Location with select trims. UL Listed for Direct Contact with Insulation and Combustible Material. UL Listed for Feed Through.

Product Number

Item	Lumens	Voltage	Dimming
E4TL16ICAD	1600 lm	120/277V	Triac/ELV/0-10V

Product Number Builder

Example: **E4TL08ICA**

ELCO Cedar 4" Trimless Housing	Lumens	IC Airtight	Dimming	Optional
E4TL				
	08 850 lm 12 1250 lm 16 1600	ICA ICA	(Blank) 120V Triac/ELV D Triac/ELV/0-10V SD Sunset L Lutron	No EM EM1 Emer. Backup up to 700 lm EM2 Emer. Backup to 1100 lm

Compatible Products

For use with 4" Cedar™ Trimless IC LED Housings

4" Cedar™ Trimless LED Light Engines

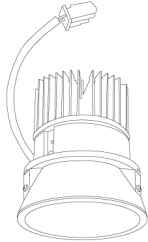

E430C
Round Reflector Trim

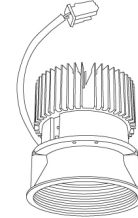

E434C
Round Baffle Trim

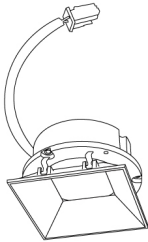

E440C
Square Reflector Trim

PRODUCT NUMBER BUILDER

Trim	Lumen	Color Temperature	Finish
<input type="text"/>	<input type="text"/>	<input type="text"/>	<input type="text"/>
E430C Reflector	08 850 lm	27 2700K	W All White
E434C Round Baffle	12 1250 lm (Round only)	30 3000K	B All Black
E440C Square Reflector	16 1600 lm (Round only)	35 3500K	BZ All Bronze
		40 4000K	
		50 5000K	
		SD Sunset Dimming	